

~~ELECTRONIC PLAN~~

UNITED STATES GOVERNMENT
MEMORANDUM

October 25, 2005

To: Public Information (MS 5034)
From: Plan Coordinator, FO, Plans Section (MS 5231)

Subject: Public Information copy of plan
Control # - N-08587
Type - Initial Exploration Plan
Lease(s) - OCS-G02109 Block - 306 Eugene Island Area
OCS-G27120 Block - 317 Eugene Island Area
Operator - Newfield Exploration Company
Description - Wells A, B, C, and D
Rig Type - JACKUP

Attached is a copy of the subject plan.

It has been deemed submitted as of this date and is under review for approval.

Elmo Cooper
Plan Coordinator

Site Type/Name	Botm Lse/Area/Blk	Surface Location	Surf Lse/Area/Blk
WELL/A	G27120/EI/317	200 FNL, 4250 FEL	G27120/EI/317
WELL/B	G27120/EI/317	4450 FSL, 650 FWL	G27120/EI/317
WELL/C	G27120/EI/317	3150 FSL, 600 FEL	G27120/EI/317
WELL/D	G02109/EI/306	200 FNL, 4250 FEL	G27120/EI/317

NOV 21 2005

PIRS

NEWFIELD



October 17, 2005

U.S. Department of the Interior
Minerals Management Service
16855 Northchase Drive
Houston, Texas 77060

Attention: Mr. Nick Wetzel
Plans Unit

RE: Joint Initial and Supplemental Exploration Plan for Leases OCS-G 02109/27120, Eugene Island Blocks 306/317, OCS Federal Waters, Gulf of Mexico, Offshore, Louisiana

Gentlemen:

In accordance with the provisions of Title 30 CFR 250.203 and that certain Notice to Lessees (NTL 2003-G17), Newfield Exploration Company (Newfield) hereby submits for your review and approval a Joint Initial and Supplemental Exploration Plan (Plan) for Leases OCS-G 02109/27120, Eugene Island Blocks 306/317, Offshore, Louisiana. Excluded from the Public Information copies are certain geologic and geophysical discussions and attachments.

Enclosed are two Proprietary Information copies (one hard copy and one CD) and four Public Information copies (one hard copy and three CD's) of the Plan.

Contingent upon receiving regulatory approvals and based on equipment and personnel availability, Newfield anticipates operations under this Plan commencing as early as January 5, 2006.

Should additional information be required, please contact the undersigned, or our regulatory representative, R.E.M. Solutions, Inc., Attention: Angie Locandro at 281.492.8562.

Sincerely,

Newfield Exploration Company

Bekki Winfree
Offshore Regulatory Manager

BW:AML
Attachments

Public Information

NEWFIELD EXPLORATION COMPANY

363 N. Sam Houston Pkwy E., Suite 2020
Houston, Texas 77060

Bekki Winfree
bwinfree@newfld.com

JOINT INITIAL AND SUPPLEMENTAL EXPLORATION PLAN

LEASES OCS-G 2109/27120

EUGENE ISLAND BLOCKS 306/317

PREPARED BY:

Angie Locandro
R.E.M. Solutions, Inc.
17171 Park Row, Suite 390
Houston, Texas 77084
281.492.8562 (Phone)
281.492.6117 (Fax)
angie@remolutionsinc.com

DATED:

October 17, 2005

SECTION A

Plan Contents

A. Description, Objectives and Schedule

Lease OCS-G 02109, Eugene Island Block 306, was acquired by Canadian Superior Oil (U.S.) Ltd., General Crude Oil Company, Highland Resources, Inc., Hunt Oil Company, Kewanee Oil Company, Placid Oil Company, The Superior Oil Company and TransOcean Oil, Inc. at the Central Gulf of Mexico Lease Sale No. 22 held on December 15, 1970. The lease was issued with an effective date of January 1, 1971 and a primary term ending date of December 31, 1975. The lease is presently maintained by ongoing production operations.

Lease OCS-G 27120, Eugene Island Block 317, was acquired by Newfield Exploration Company at the Central Gulf of Mexico Lease Sale No. 194 held on March 16, 2005. The lease was issued with an effective date of June 1, 2005 and a primary term ending date of May 31, 2010.

The current lease operatorship and ownership are as follows:

Area/Block Lease No.	Operator	Ownership
Eugene Island Block 306 Lease OCS-G 2109	Apache Corporation	Hunt Oil Company Apache Corporation Lamar Hunt Trust Estate North Gulfsands, LLC Hunt Petroleum Corporation The George R. Brown Partnership, L.P. F.C.H. Operating Company Mission Resources Corporation

Area/Block Lease No.	Operator	Ownership
East Cameron Block 317 Lease OCS-G 27120	Newfield Exploration Company	Newfield Exploration Company

Newfield Exploration Company is in the process of being designated operator of a aliquot portion of Lease OCS-G 02109, Eugene Island Block 306.

Newfield proposes to drill, complete, test and mudline suspension on Well Locations A through D in Eugene Island Blocks 306/317 from surface locations in Eugene Island Block 317. Information pertaining to the geological targets, including a narrative of trapping features, is included as *Attachment A-1*.

SECTION A

Contents of Plan - Continued

B. Location

Included are the following attachments:

- | | |
|-------------------------------|---|
| <i>Attachment A-2:</i> | Form MMS-137 "OCS Plan Information Form" |
| <i>Attachment A-3:</i> | Well Location Plats |
| <i>Attachment A-4:</i> | Bathymetry map detailing the proposed well surface location disturbance areas |

C. Drilling Unit

Newfield will utilize a typical jack-up type drilling rig for the proposed drilling, completion and testing and mudline suspension operations provided for in this Plan. Actual rig specifications will be included with the Applications for Permit to Drill.

Safety of personnel and protection of the environment during the proposed operations is of primary concern with Newfield, and mandates regulatory compliance with the contractors and vendors associated with the proposed operations as follows:

Minerals Management Service regulations contained in Title 30 CFR Part 250, Subparts C, D, E, and O mandate the operations comply with well control, pollution prevention, construction and welding procedures as described in Title 30 CFR Part 250, Subparts C, D, E, and O; and as further clarified by MMS Notices to Lessees.

Minerals Management Service conducts periodic announced and unannounced onsite inspections of offshore facilities to confirm operators are complying with lease stipulations, operating regulations, approved plans, and other conditions; as well as to assure safety and pollution prevention requirements are being met. The National Potential Incident of Noncompliance (PINC) List serves as the baseline for these inspections.

U. S. Coast Guard regulations contained in Title 33 CFR mandate the appropriate life rafts, life jackets, ring buoys, etc., be maintained on the facility at all times.

U. S. Environmental Protection Agency regulations contained in the NPDES General Permit GMG290000 mandate that supervisory and certain designated personnel on-board the facility be familiar with the effluent limitations and guidelines for overboard discharges into the receiving waters.

Geological Targets and Trapping Features

**Attachment A-1
(Proprietary Information)**

OCS Plan Information Form

**Attachment A-2
(Public Information)**

OCS PLAN INFORMATION FORM

General Information													
Type of OCS Plan	<input checked="" type="checkbox"/>	Exploration Plan (EP)		Development Operations Coordination Document (DOCD)									
Company Name:	Newfield Exploration Company				MMS Operation Number: 01364								
Address:	363 N. Sam Houston Pkwy E., Suite 2020				Contact Person: Angie Locandro								
	Houston, Texas 77060				Phone Number: 281.492.8562								
					E-Mail Address: angie@remolutionsinc.com								
Lease(s):	OCS-G 02109 / 27120		Area:	EI		Block(s):	306/317		Project Name (If Applicable): NA				
Objective(s):	<input type="checkbox"/>	Oil	<input checked="" type="checkbox"/>	Gas	<input type="checkbox"/>	Sulphur	<input type="checkbox"/>	Salt	Shorebase: Fourchon, LA		Distance to Closest Land (Miles): 68		
Description of Proposed Activities (Mark all that apply)													
<input checked="" type="checkbox"/>	Exploration drilling				<input type="checkbox"/> Development drilling								
<input checked="" type="checkbox"/>	Well completion				<input type="checkbox"/> Installation of production platform								
<input checked="" type="checkbox"/>	Well test flaring (for more than 48 hours)				<input type="checkbox"/> Installation of production facilities								
<input type="checkbox"/>	Installation of caisson or platform as well protection structure				<input type="checkbox"/> Installation of satellite structure								
<input type="checkbox"/>	Installation of subsea wellheads and/or manifolds				<input type="checkbox"/> Commence production								
<input type="checkbox"/>	Installation of lease term pipelines				<input type="checkbox"/> Other (Specify and describe)								
Have you submitted or do you plan to submit a Conservation Information Document to accompany this plan?										<input type="checkbox"/>	Yes	<input checked="" type="checkbox"/>	No
Do you propose to use new or unusual technology to conduct your activities?										<input type="checkbox"/>	Yes	<input checked="" type="checkbox"/>	No
Do you propose any facility that will serve as a host facility for deepwater subsea development?										<input type="checkbox"/>	Yes	<input checked="" type="checkbox"/>	No
Do you propose any activities that may disturb an MMS-designated high-probability archaeological area?										<input type="checkbox"/>	Yes	<input checked="" type="checkbox"/>	No
Have all of the surface locations of your proposed activities been previously reviewed and approved by MMS?										<input type="checkbox"/>	Yes	<input checked="" type="checkbox"/>	No
Tentative Schedule of Proposed Activities													
Proposed Activity						Start Date		End Date		No. of Days			
Drill, Complete, Test and Mudline Suspend Well Location A						01/05/2006		02/10/2006		36			
Drill, Complete, Test and Mudline Suspend Well Location B						08/01/2006		09/15/2006		46			
Drill, Complete, Test and Mudline Suspend Well Location C						03/01/2007		04/07/2007		38			
Drill, Complete, Test and Mudline Suspend Well Location D						10/01/2007		11/15/2007		46			
Description of Drilling Rig						Description of Production Platform							
<input checked="" type="checkbox"/>	Jackup		<input type="checkbox"/>	Drillship		<input type="checkbox"/>	Caisson		<input type="checkbox"/>	Tension Leg Platform			
<input type="checkbox"/>	Gorilla Jackup		<input type="checkbox"/>	Platform rig		<input type="checkbox"/>	Well protector		<input type="checkbox"/>	Compliant tower			
<input type="checkbox"/>	Semi-submersible		<input type="checkbox"/>	Submersible		<input type="checkbox"/>	Fixed Platform		<input type="checkbox"/>	Guyed tower			
<input type="checkbox"/>	DP Semi-submersible		<input type="checkbox"/>	Other (Attach description)		<input type="checkbox"/>	Subsea manifold		<input type="checkbox"/>	Floating production system			
Drilling Rig Name (if known):						Spar		Other (Attach Description)					
Description of Lease Term Pipelines													
From (Facility/Area/Block)			To (Facility/Area/Block)			Diameter (Feet)			Length (Feet)				
NA													

OCS PLAN INFORMATION FORM (CONTINUED)
Include one copy of this page for each proposed well/structure

Proposed Well/Structure Location					
Well or Structure Name/Number (If renaming well or structure, reference previous name): Well Location A					Subsea Completion
Anchor Radius (if applicable) in feet: NA					<input type="checkbox"/> Yes <input checked="" type="checkbox"/> X <input type="checkbox"/> No
	Surface Location			Bottom-Hole Location (For Wells)	
Lease No.	OCS-G 27120			OCS-G 27120	
Area Name	Eugene Island			Eugene Island	
Block No.	317			317	
Blockline Departures (in feet)	N/S Departure	200'	F N L	N/S Departure:	
	E/W Departure	4250'	F E L	E/W Departure:	
Lambert X-Y coordinates	X: 1,920,639			X:	
	Y: -136,268			Y:	
Latitude / Longitude	Latitude: 28.291752455			Latitude:	
	Longitude: 91.579827242			Longitude:	
	TVD (Feet):		MD (Feet):		Water Depth (Feet): 232'
Anchor Locations for Drilling Rig or Construction Barge (If anchor radius supplied above, not necessary)					
Anchor Name or No.	Area	Block	X Coordinate	Y Coordinate	Length of Anchor Chain on Seafloor
NA			X=	Y=	
			X=	Y=	
			X=	Y=	
			X=	Y=	
			X=	Y=	
			X=	Y=	
			X=	Y=	
			X=	Y=	
<p>Paperwork Reduction Act of 1995 Statement: The Paperwork Reduction Act of 1995 (44 U.S.C. Chapter 35) requires us to inform you that MMS collects this information as part of an applicant's Exploration Plan or Development Operations Coordination Document submitted for MMS approval. We use the information to facilitate our review and data entry for OCS plans. We will protect proprietary data according to the Freedom of Information Act and 30 CFR 250.196. An agency may not conduct or sponsor, and a person is not required to respond to, a collection of information unless it displays a currently valid Office of Management and Budget Control Number. The use of this form is voluntary. The public reporting burden for this form is included in the burden for preparing Exploration Plans and Development Operations Coordination Documents. We estimate that burden to average 580 hours per response, including the time for reviewing instructions, gathering and maintaining data, and completing and reviewing the form. Direct comments regarding the burden estimate or any other aspect of this form to the Information Collection Clearance Officer, Mail Stop 4230, Minerals Management Service, 1849 C Street, N.W., Washington, DC 20240.</p>					

OCS PLAN INFORMATION FORM (CONTINUED)
Include one copy of this page for each proposed well/structure

Proposed Well/Structure Location					
Well or Structure Name/Number (If renaming well or structure, reference previous name): Well Location B					Subsea Completion
Anchor Radius (if applicable) in feet: NA					<input type="checkbox"/> Yes <input checked="" type="checkbox"/> X <input type="checkbox"/> No
	Surface Location			Bottom-Hole Location (For Wells)	
Lease No.	OCS-G 27120			OCS-G 27120	
Area Name	Eugene Island			Eugene Island	
Block No.	317			317	
Blockline Departures (in feet)	N/S Departure 4450' F S L			N/S Departure:	
	E/W Departure 650' F W L			E/W Departure:	
Lambert X-Y coordinates	X: 1,910,518			X:	
	Y: -146,116			Y:	
Latitude / Longitude	Latitude: 28.264612811			Latitude:	
	Longitude: 91.611188609			Longitude:	
TVD (Feet):		MD (Feet):		Water Depth (Feet): 240'	
Anchor Locations for Drilling Rig or Construction Barge (If anchor radius supplied above, not necessary)					
Anchor Name or No.	Area	Block	X Coordinate	Y Coordinate	Length of Anchor Chain on Seafloor
NA			X=	Y=	
			X=	Y=	
			X=	Y=	
			X=	Y=	
			X=	Y=	
			X=	Y=	
			X=	Y=	
			X=	Y=	
Paperwork Reduction Act of 1995 Statement: The Paperwork Reduction Act of 1995 (44 U.S.C. Chapter 35) requires us to inform you that MMS collects this information as part of an applicant's Exploration Plan or Development Operations Coordination Document submitted for MMS approval. We use the information to facilitate our review and data entry for OCS plans. We will protect proprietary data according to the Freedom of Information Act and 30 CFR 250.196. An agency may not conduct or sponsor, and a person is not required to respond to, a collection of information unless it displays a currently valid Office of Management and Budget Control Number. The use of this form is voluntary. The public reporting burden for this form is included in the burden for preparing Exploration Plans and Development Operations Coordination Documents. We estimate that burden to average 580 hours per response, including the time for reviewing instructions, gathering and maintaining data, and completing and reviewing the form. Direct comments regarding the burden estimate or any other aspect of this form to the Information Collection Clearance Officer, Mail Stop 4230, Minerals Management Service, 1849 C Street, N.W., Washington, DC 20240.					

OCS PLAN INFORMATION FORM (CONTINUED)
Include one copy of this page for each proposed well/structure

Proposed Well/Structure Location					
Well or Structure Name/Number (If renaming well or structure, reference previous name): Well Location C					Subsea Completion
Anchor Radius (if applicable) in feet: NA					<input type="checkbox"/> Yes <input checked="" type="checkbox"/> X <input type="checkbox"/> No
	Surface Location			Bottom-Hole Location (For Wells)	
Lease No.	OCS-G 27120			OCS-G 27120	
Area Name	Eugene Island			Eugene Island	
Block No.	317			317	
Blockline Departures (in feet)	N/S Departure	3150'	F S L	N/S Departure:	
	E/W Departure	600'	F E L	E/W Departure:	
Lambert X-Y coordinates	X: 1,924,289			X:	
	Y: -147,418			Y:	
Latitude / Longitude	Latitude: 28.261123367			Latitude:	
	Longitude: 91.568419401			Longitude:	
TVD (Feet):		MD (Feet):		Water Depth (Feet): 243'	
Anchor Locations for Drilling Rig or Construction Barge (If anchor radius supplied above, not necessary)					
Anchor Name or No.	Area	Block	X Coordinate	Y Coordinate	Length of Anchor Chain on Seafloor
NA			X=	Y=	
			X=	Y=	
			X=	Y=	
			X=	Y=	
			X=	Y=	
			X=	Y=	
			X=	Y=	
			X=	Y=	
<p>Paperwork Reduction Act of 1995 Statement: The Paperwork Reduction Act of 1995 (44 U.S.C. Chapter 35) requires us to inform you that MMS collects this information as part of an applicant's Exploration Plan or Development Operations Coordination Document submitted for MMS approval. We use the information to facilitate our review and data entry for OCS plans. We will protect proprietary data according to the Freedom of Information Act and 30 CFR 250.196. An agency may not conduct or sponsor, and a person is not required to respond to, a collection of information unless it displays a currently valid Office of Management and Budget Control Number. The use of this form is voluntary. The public reporting burden for this form is included in the burden for preparing Exploration Plans and Development Operations Coordination Documents. We estimate that burden to average 580 hours per response, including the time for reviewing instructions, gathering and maintaining data, and completing and reviewing the form. Direct comments regarding the burden estimate or any other aspect of this form to the Information Collection Clearance Officer, Mail Stop 4230, Minerals Management Service, 1849 C Street, N.W., Washington, DC 20240.</p>					

OCS PLAN INFORMATION FORM (CONTINUED)
Include one copy of this page for each proposed well/structure

Proposed Well/Structure Location					
Well or Structure Name/Number (If renaming well or structure, reference previous name): Well Location D					Subsea Completion
Anchor Radius (if applicable) in feet: NA					<input type="checkbox"/> Yes <input checked="" type="checkbox"/> X <input type="checkbox"/> No
	Surface Location		Bottom-Hole Location (For Wells)		
Lease No.	OCS-G 27120		OCS-G 02109		
Area Name	Eugene Island		Eugene Island		
Block No.	317		306		
Blockline Departures (in feet)	N/S Departure	200'	F N L	N/S Departure:	
	E/W Departure	4250'	F E L	E/W Departure:	
Lambert X-Y coordinates	X: 1,920,639		X:		
	Y: -136,268		Y:		
Latitude / Longitude	Latitude: 28.291752455		Latitude:		
	Longitude: 91.579827242		Longitude:		
TVD (Feet):		MD (Feet):		Water Depth (Feet): 232'	
Anchor Locations for Drilling Rig or Construction Barge (If anchor radius supplied above, not necessary)					
Anchor Name or No.	Area	Block	X Coordinate	Y Coordinate	Length of Anchor Chain on Seafloor
NA			X=	Y=	
			X=	Y=	
			X=	Y=	
			X=	Y=	
			X=	Y=	
			X=	Y=	
			X=	Y=	
			X=	Y=	

Paperwork Reduction Act of 1995 Statement: The Paperwork Reduction Act of 1995 (44 U.S.C. Chapter 35) requires us to inform you that MMS collects this information as part of an applicant's Exploration Plan or Development Operations Coordination Document submitted for MMS approval. We use the information to facilitate our review and data entry for OCS plans. We will protect proprietary data according to the Freedom of Information Act and 30 CFR 250.196. An agency may not conduct or sponsor, and a person is not required to respond to, a collection of information unless it displays a currently valid Office of Management and Budget Control Number. The use of this form is voluntary. The public reporting burden for this form is included in the burden for preparing Exploration Plans and Development Operations Coordination Documents. We estimate that burden to average 580 hours per response, including the time for reviewing instructions, gathering and maintaining data, and completing and reviewing the form. Direct comments regarding the burden estimate or any other aspect of this form to the Information Collection Clearance Officer, Mail Stop 4230, Minerals Management Service, 1849 C Street, N.W., Washington, DC 20240.

Well Location Plat

**Attachment A-3
(Public Information)**

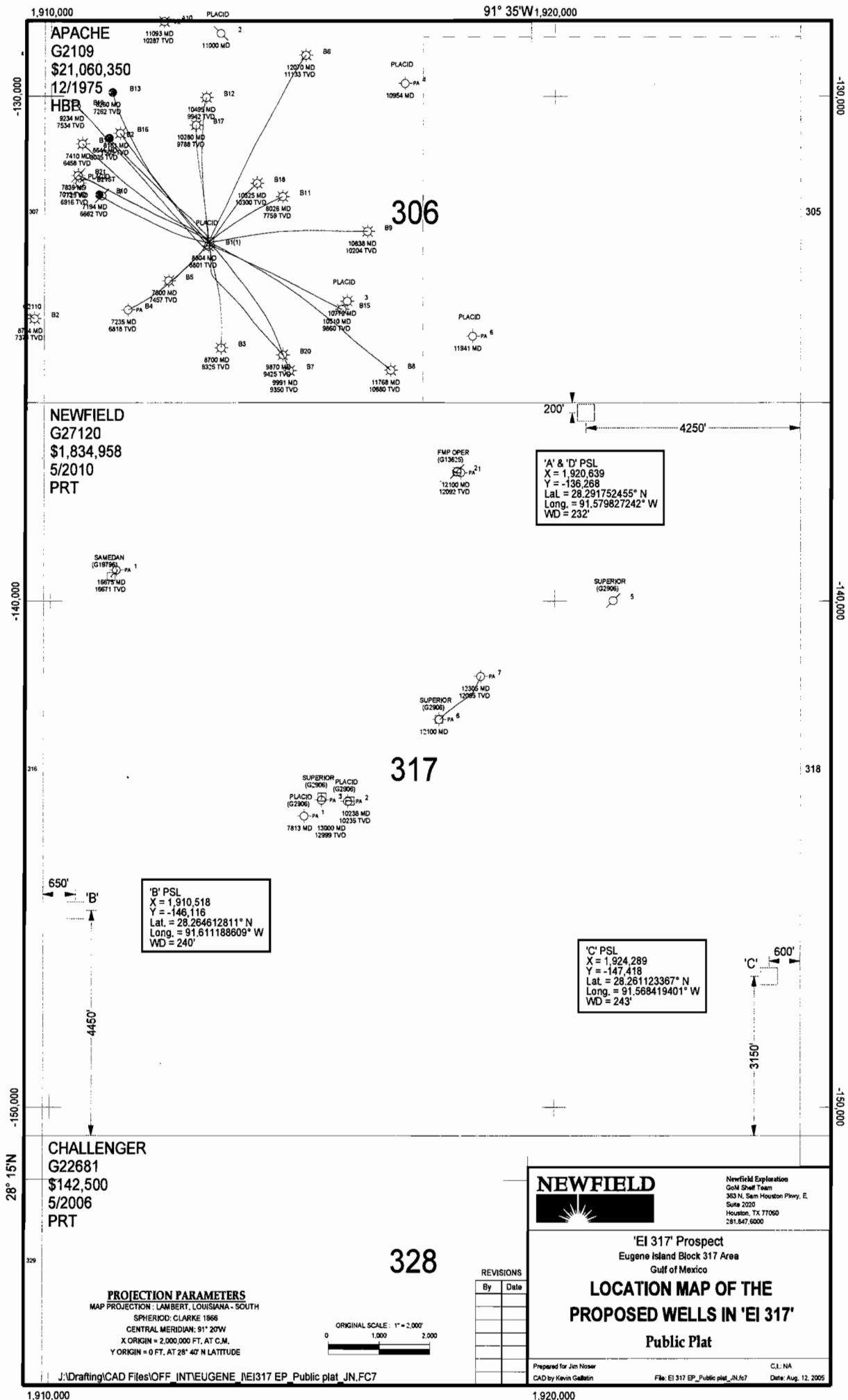

APACHE
G2109
\$21,060,350
12/1975

HBR

NEWFIELD
G27120
\$1,834,958
5/2010
PRT

CHALLENGER
G22681
\$142,500
5/2006
PRT

PROJECTION PARAMETERS
MAP PROJECTION: LAMBERT, LOUISIANA - SOUTH
SPHEROID: CLARKE 1866
CENTRAL MERIDIAN: 91° 20'W
X ORIGIN = 2,000,000 FT. AT C.M.
Y ORIGIN = 0 FT. AT 28° 40' N LATITUDE

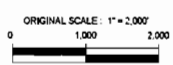

REVISIONS	
By	Date



Newfield Exploration
GoM Shelf Team
363 N. Sam Houston Pkwy, E.
Suite 2020
Houston, TX 77060
281.847.6000

'EI 317' Prospect
Eugene Island Block 317 Area
Gulf of Mexico

**LOCATION MAP OF THE
PROPOSED WELLS IN 'EI 317'**

Public Plat

Prepared for Jim Noser
CAD by Kevin Gallatin

C.J.: NA
Date: Aug. 12, 2005

Bathymetry Map

**Attachment A-4
(Public Information)**

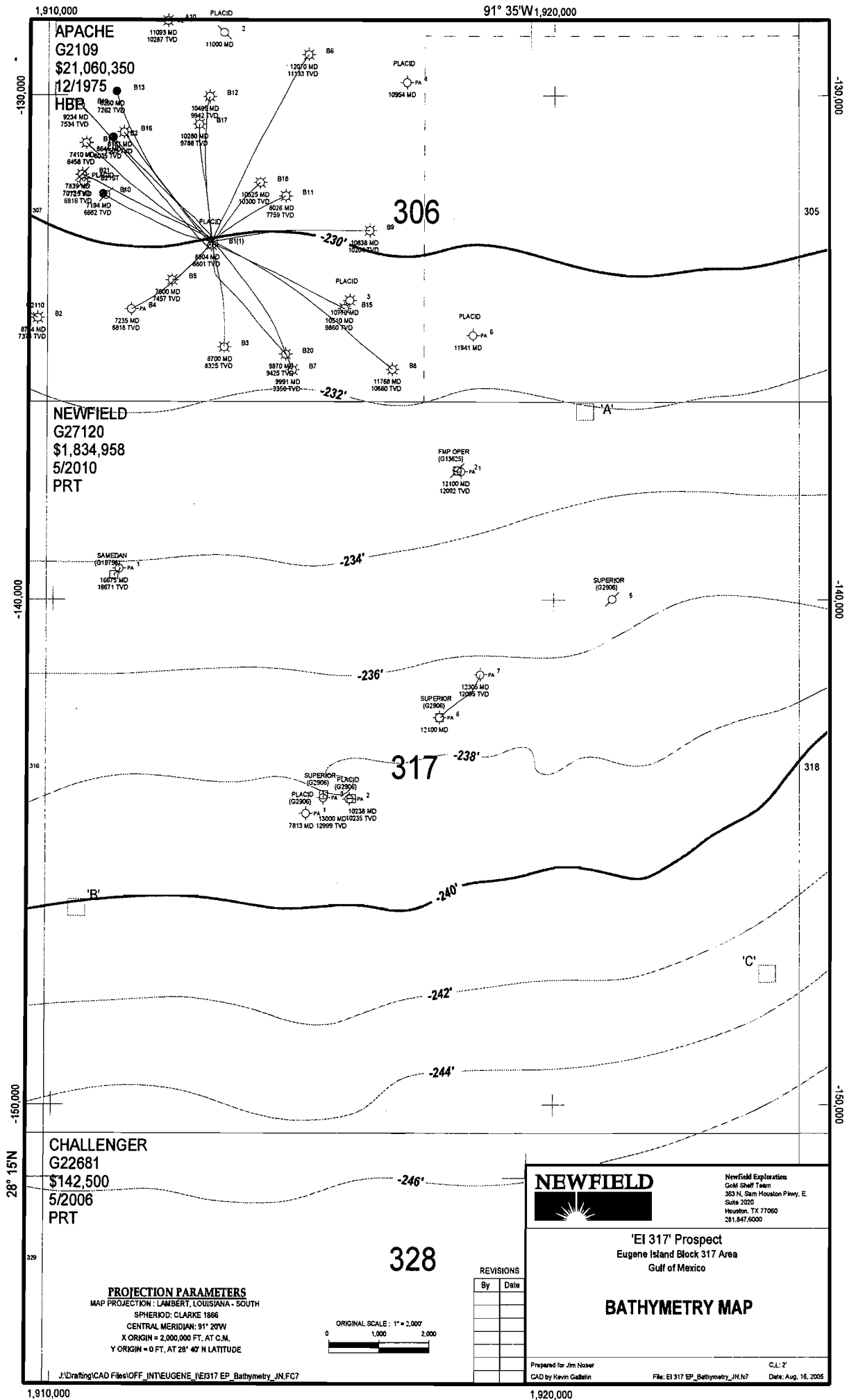

Typical Well Protector Elevation Drawing

**Attachment A-5
(Public Information)**

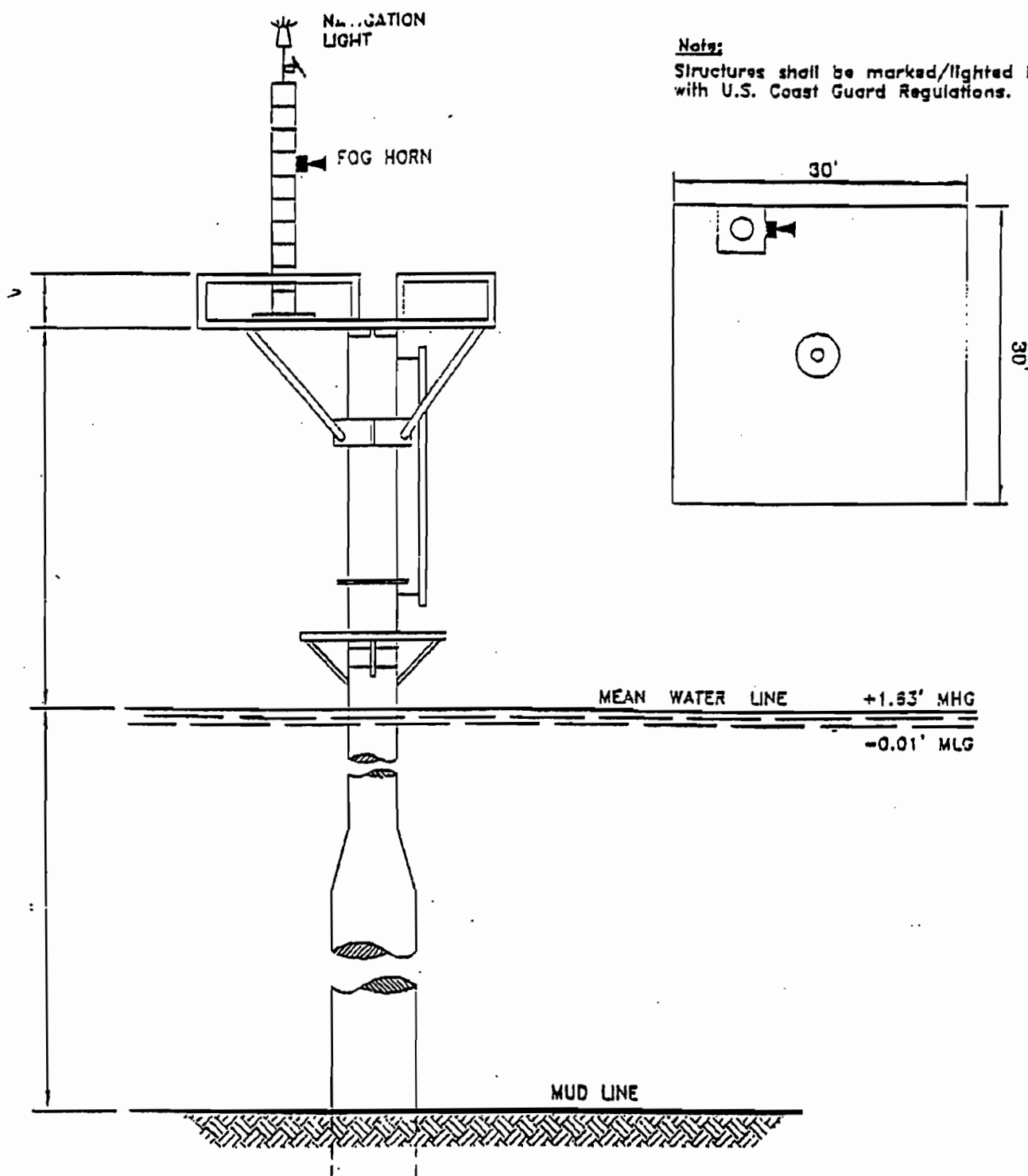

Note:
Structures shall be marked/lighted in accordance with U.S. Coast Guard Regulations.

TYPICAL CAISSON WELL PROTECTOR

SECTION B

General Information

A. Contact

Questions or requests for additional information should be made to Newfield's authorized representative for this project:

Angie Locandro
R.E.M. Solutions, Inc.
17171 Park Row, Suite 390
Houston, Texas 77084
281.492.8562 (Phone)
281.492.6117 (Fax)
angie@remolutionsinc.com

B. Prospect Name

Newfield does not refer to prospect names for their exploratory activities.

C. New or Unusual Technology

Newfield does not propose using any new and/or unusual technology for the operations proposed in this Plan.

D. Bonding Information

In accordance with Title 30 CFR Part 256, Subpart I, Newfield elected and has on file with the Minerals Management Service Gulf of Mexico Regional Office a \$3,000,000 Areawide Development Bond.

As deemed warranted, Minerals Management Service will contact the designated operator in the event a supplemental bond is required for the proposed operations, as outlined in Notice to Lessees (NTL) 2003-N06 to cover plugging liability of the wellbores, removal of associated well protector structures and site clearance.

Newfield is on the exempt list with the Minerals Management Service for supplemental bonding.

E. Onshore Base and Support Vessels

The proposed surface disturbance in Eugene Island Blocks 306/317 will be located approximately 68 miles from the nearest Louisiana shoreline, and approximately 104 miles from the onshore support base to be located in Fourchon, Louisiana.

SECTION B

General Information - Continued

Newfield will use an existing onshore base to accomplish the following routine operations:

- Loading/Offloading point for equipment supporting the offshore operations,
- Dispatching personnel and equipment, and does not anticipate the need for any expansion of the selected facilities as a result of the activities proposed in this Plan,
- Temporary storage for materials and equipment
- 24-Hour Dispatcher

Personnel involved in the proposed operations will typically use their own vehicles as transportation to and from the selected onshore base; whereas the selected vendors will transport the equipment by a combination of trucks, boats and/or helicopters to the onshore base. The personnel and equipment will then be transported to the drilling rig via the transportation methods and frequencies shown below, taking the most direct route feasible as mandated by weather and traffic conditions:

Support Vessel	Drilling and Completion Trips Per Week
Crew Boat	3
Supply Boat	5
Helicopter	7

The proposed operations are temporary in nature and do not require any immediate action to acquire additional land, expand existing base facilities.

A Vicinity Plat showing the surface location in Eugene Island Block 317 relative to the shoreline and onshore base is included as *Attachment B-1*.

F. Lease Stipulations

Under the Outer Continental Shelf Lands Act, the Minerals Management Service is charged with the responsibility of managing and regulating the exploration and development on the OCS. As part of the regulatory process, an Environmental Impact Statement (EIS) is prepared for each lease sale, at which time mitigation measures are addressed in the form of lease stipulations, which then become part of the oil and gas lease terms and are therefore enforceable as part of that lease.

As part of this process, the designated operator proposing to conduct related exploratory and development activities, must review the applicable lease stipulations, as well as other special conditions, which may be imposed by the Minerals Management Service, and other governing agencies.

The proposed surface locations in Eugene Island Block 317 are subject to the following such stipulation and conditions:

SECTION B

General Information - Continued

Military Warning Area

The hold and save harmless section of the Military Areas Stipulation serves to protect the U.S. Government from liability in the event of an accident involving the designated oil and gas lease operator and military activities.

The electromagnetic emissions section of the stipulation requires the operator and its agents to reduce and curtail the use of radio or other equipment emitting electromagnetic energy within some areas.

This serves to reduce the impact of oil and gas activity on the communications of military missions and reduces the possible effects of electromagnetic energy transmissions on missile testing, tracking, and detonation.

The operational section requires notification to the military of oil and gas activity to take place within a military use area. This allows the base commander to plan military missions and maneuvers that may avoid the areas where oil and gas activities are taking place or to schedule around these activities. Prior notification helps reduce the potential impacts associated with vessels and helicopters traveling unannounced through areas where military activities are underway.

The Military Areas Stipulation reduces potential impacts, particularly in regards to safety, but does not reduce or eliminate the actual physical presence of oil and gas operations in areas where military operations are conducted.

The reduction in potential impacts resulting from this stipulation makes multiple-use conflicts most unlikely. Without the stipulation, some potential conflict is likely. The best indicator of the overall effectiveness of the stipulation may be that there has never been an accident involving a conflict between military operations and oil and gas activities.

The proposed surface disturbance in Eugene Block 317 is located within Military Warning Area W-59. Therefore, in accordance with the requirements of the referenced stipulation, Newfield will contact the Naval Air Station-JRB 159 Fighter Wing in order to coordinate and control the electromagnetic emissions during the proposed operations.

Marine Protected Species

Lease Stipulation No. 6 is to reference measures to minimize or avoid potential adverse impacts to protected species (sea turtles, marine mammals, gulf sturgeon, and other federally protected species). MMS has issued Notice to Lessees NTL 2004-G01 "Implementation of Seismic Mitigation Measures and Protected Species Observer Program", NTL 2003-G10

SECTION B

General Information - Continued

“Vessel Strike Avoidance and Injured/Dead Protected Species Reporting” and NTL 2003-G11 “Marine Trash and Debris Awareness and Elimination”.

Special Conditions

The proposed surface disturbance activity in Eugene Island Block 317 will not be affected by any additional special conditions and/or multiple uses, such as designated shipping/anchorage areas, lightering zones, rigs-to-reef zone, and ordnance disposal zones.

Vicinity Plat

**Attachment B-1
(Public Information)**

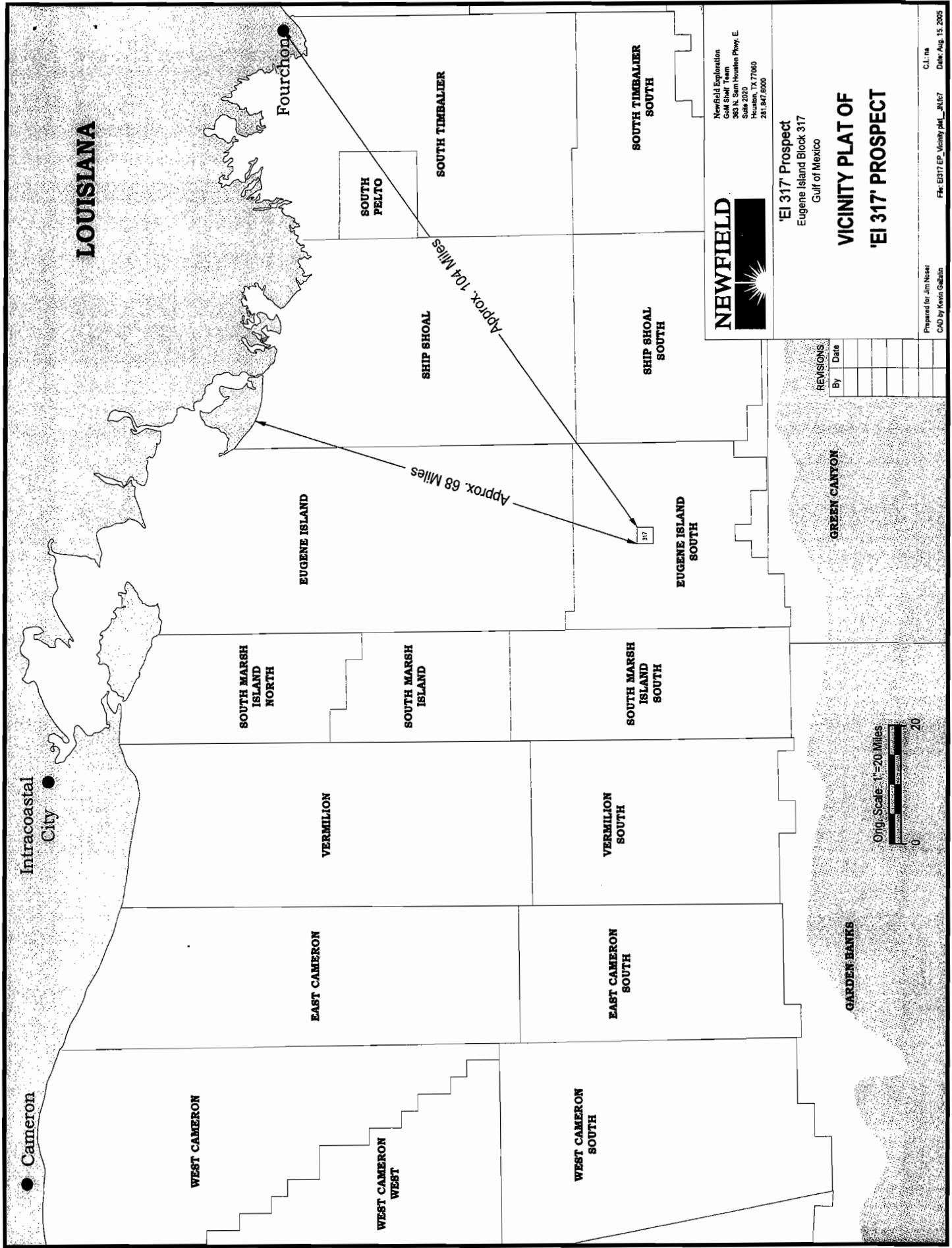

SECTION C

Geological, Geophysical & H2S Information

A. Structure Contour Maps

Included as *Attachment C-1* are current structure maps (depth base and expressed in feet subsea) depicting the entire lease coverage area; drawn on the top of each prospective hydrocarbon sand. The maps depict each proposed bottom hole location and applicable geological cross section.

B. Interpreted Deep Seismic Lines

Included as *Attachment C-2*, (the original copy only,) is a page size copy of the migrated and annotated (shot point, time lines, well paths) of the deep seismic line within 500 feet of the surface location.

C. Geological Structure Cross Sections

An interpreted geological cross section depicting the proposed well locations and depth of the proposed wells is included as *Attachment C-3*. Such cross section corresponds to each seismic line being submitted under separate cover.

D. Shallow Hazards Report

Gulf Ocean conducted a high resolution geophysical survey in Eugene Island Block 317 during December 1999 on behalf of Samedan Oil Corporation. Approval was obtained by Newfield Exploration Company to utilize this pre-existing data. The purpose of the survey was to evaluate geologic conditions and inspect for potential hazards or constraints to lease development.

Copies of these updated reports are being submitted to the Minerals Management Service under separate cover.

E. Shallow Hazards Assessment

A shallow hazards analysis has been prepared for the proposed surface locations, evaluating seafloor and subsurface geologic and manmade features and conditions, and is included as *Attachment C-4*.

F. High Resolution Seismic Lines

Included as *Attachment C-5* is a copy of the transmittal letter of the annotated high resolution survey data lines for each surface location disturbance proposed in this Plan.

SECTION C

Geological, Geophysical & H2S Information-Continued

G. Stratigraphic Column

A generalized biostratigraphic/lithostratigraphic column from the seafloor to the total depth of the proposed wells is included as *Attachment C-6*.

H. Time Vs. Depth Tables

Newfield has determined that there is existing sufficient well control data for the target areas proposed in this plan; therefore, tables providing seismic time versus depth for the proposed well locations are not required.

I. Hydrogen Sulfide Classification

In accordance with Title 30 CFR 250.490, Newfield requests that Eugene Island Block 317 be classified by the Minerals Management Service as an area where the absence of hydrogen sulfide has been confirmed based on the following wells which were drilled to the stratigraphic equivalent of the wells proposed in this Plan:

<i>Lease</i>	<i>Area/Block</i>	<i>Well No.</i>

Structure Maps

**Attachment C-1
(Proprietary Information)**

Deep Seismic Lines

**Attachment C-2
(Proprietary Information)**

Cross Section Maps

**Attachment C-3
(Proprietary Information)**

Shallow Hazards Assessment

**Attachment C-4
(Public Information)**

High-resolution shallow hazard data has been interpreted for seismic anomalies, man-made structures and possible near surface drilling hazards.

The seafloor in Eugene Island 317 dips south from 232' in the north to 246' in the south. Seafloor sediments are interpreted to consist of silty clays with occasional silt and sand lenses. These Holocene sediments range in thickness from 60' in the north to 68' in the south.

A number of man-made features are on the block. Magnetometer and side scan data locate various drillsites and pipelines. Location A is 2150' northwest of the Devon 14" oil pipeline. Location B is 500' southeast of the Devon 14" pipeline and 1900' west of the Conoco Phillips 12" oil pipeline. Location C is not near any mapped pipelines. These pipelines should pose no problem to operations at any proposed location.

Location A is 2800' northeast of the Freeport McMoRan OCS-G13625 No. 1 well drilled to 1200' md, 12093 tvd in 1993. This drillsite should pose no problem to operations at this location.

Subbottom profiler and analog sparker data illustrate the seismic character of the shallow sediments in Eugene Island Block 317. A number of anomalies are identified in the report. These anomalies are associated with two different periods of deposition. A series of anomalies associated with Horizon A, the Holocene/Pleistocene boundary are illustrated in Figure 2. These anomalies are interpreted to be associated with the fill of early Holocene channels. Location A is 300' southeast of the eastern margin of one of these anomalies and 1000' west of the western margin of a second anomaly. These anomalies should not affect operations at Location A. Locations B and C are not near any of these anomalies.

A second anomaly set is immediately below Horizon B and is illustrated in Figure 4. Location B is 300' south of the southern boundary of an anomaly north of location B. Location C is 1000' west of an east west elongate anomaly and should not be affected by this anomaly. A large anomaly occupies the northern half of Eugene Island 317 and is outlined on Structure Map 4. Location A is within this anomaly. Caution will be exercised when drilling through this anomaly.

Keith Davis
Geophysicist

Shallow Hazards Lines Transmittal Letter

**Attachment C-5
(Proprietary Information)**

Stratigraphic Column

**Attachment C-6
(Proprietary Information)**

SECTION D

Biological and Physical Information

A. Chemosynthetic Information

The proposed seafloor disturbing activities are in water depths less than 400 meters (1312 feet); therefore, this section of the Plan is not applicable.

B. Topographic Features Information

MMS and the National Marine Fisheries Service (NMFS) have entered into a programmatic consultation agreement for Essential Fish Habitat that requires that no bottom disturbing activities, including anchors or cables from a semi-submersible drilling rig, may occur within 500 feet of the no-activity zone of a topographic feature. If such proposed bottom disturbing activities are within 500 feet of a no activity zone, the MMS is required to consult with the NMFS.

The activities proposed in this Plan are not affected by a topographic feature.

C. Live Bottom (Pinnacle Trend) Information

Certain leases are located in areas characterized by the existence of live bottoms. Live bottom areas are defined as seagrass communities; those areas that contain biological assemblages consisting of sessile invertebrates living upon and attached to naturally occurring hard or rocky formations with rough, broken, or smooth topography; and areas where the lithotope favors the accumulation of turtles, fishes, or other fauna. These leases contain a Live Bottom Stipulation to ensure that impacts from nearby oil and gas activities on these live bottom areas are mitigated to the greatest extent possible.

For each affected lease, the Live Bottom Stipulation requires that you prepare a live bottom survey report containing a bathymetry map prepared by using remote sensing techniques. This report must be submitted to the Gulf of Mexico OCS Region (GOMR) before you may conduct any drilling activities or install any structure, including lease term pipelines in accordance with NTL 99-G16.

The proposed surface locations in Eugene Island Block 317 are not located within the vicinity of a proposed live bottom area.

D. Remotely Operated Vehicle (ROV Surveys)

Pursuant to NTL No. 2003-G03, operators may be required to conduct remote operated vehicle (ROV) surveys during pre-spudding and post-drilling operations for the purpose of biological and physical observations.

Eugene Island Block 317 is not located within an area where ROV Surveys are required.

SECTION D

Biological and Physical Information-Continued

E. Archaeological Reports

In conjunction with this geophysical survey, an archaeological survey and report was also prepared to comply with the requirements of NTL 2005-G07, as Eugene Island Blocks 306 & 317 is located within an area for potential archaeological resources.

This requirement provides protection of prehistoric and historic archaeological resources by requiring remote sensing surveys in areas designated to have a high probability for archaeological resources.

The proposed surface locations in Eugene Island Blocks 306 & 317 are classified by MMS as a low probability area for archaeological resources; therefore, an archaeological survey is not required.

SECTION E

Wastes and Discharge/Disposal Information

The Minerals Management Service (MMS), U. S. Coast Guard (USCG) and the U.S. Environmental Protection Agency (EPA) regulate the overboard discharge and/or disposal of operational waste associated with drilling, completing, testing and/or production operations from oil and gas exploration and production activities.

Minerals Management Service regulations contained in Title 30 CFR 250.300 require operators to "prevent the unauthorized discharge of pollutants into offshore waters". These same regulations prohibit the intentional disposal of "equipment, cables, chains, containers, or other materials" offshore. Small items must be stored and transported in clearly marked containers and large objects must be individually marked. Additionally, items lost overboard must be recorded in the facility's daily log and reported to MMS as appropriate.

U. S. Coast Guard regulations implement the Marine Pollution Research and Control Act (MARPOL) of 1987 requiring manned offshore rigs, platforms and associated vessels prohibit the dumping of all forms of solid waste at sea with the single exception of ground food wastes, which can be discharged if the facility is beyond 12 nautical miles from the nearest shore. This disposal ban covers all forms of solid waste including plastics, packing material, paper, glass, metal, and other refuse. These regulations also require preparation, monitoring and record keeping requirements for garbage generated on board these facilities. The drilling contractor must maintain a Waste Management Plan, in addition to preparation of a Daily Garbage Log for the handling of these types of waste. MODU's are equipped with bins for temporary storage of certain garbage. Other types of waste, such as food, may be discharged overboard if the discharge can pass through 25-millimeter type mesh screen. Prior to off loading and/or overboard disposal, an entry will be made in the Daily Garbage Log stating the approximate volume, the date of action, name of the vessel, and destination point.

U. S. Environmental Protection Agency regulations address the disposal of oil and gas operational wastes under three Federal Acts. The Resource Conservation and Recovery Act (RCRA) which provides a framework for the safe disposal of discarded materials, regulating the management of solid and hazardous wastes. The direct disposal of operational wastes into offshore waters is limited under the authority of the Clean Water Act. And, when injected underground, oil and gas operational wastes are regulated by the Underground Injection Control program. If any wastes are classified as hazardous, they are to be properly transported using a uniform hazardous waste manifest, documented, and disposed at an approved hazardous waste facility.

A National Pollutant Discharge Elimination System (NPDES) permit, based on effluent limitation guidelines, is required for any discharges into offshore waters. Newfield has requested coverage under the Region VI NPDES General Permit GMG290000 for discharges associated with exploration and development activities in Eugene Island Block 317 and will take applicable steps to ensure all offshore discharges associated with the proposed operations will be conducted in accordance with the permit.

SECTION E

Wastes and Discharge/Disposal Information-Continued

A. Composition of Solid and Liquid Wastes

The major operational solid waste in the largest quantities generated from the proposed operations will be the drill cuttings, drilling and/or completion fluids. Other associated wastes include waste chemicals, cement wastes, sanitary and domestic waste, trash and debris, ballast water, storage displacement water, rig wash and deck drainage, hydraulic fluids, used oil, oily water and filters, and other miscellaneous minor discharges.

These wastes are generated into categories, being solid waste (trash and debris), nonhazardous oilfield waste (drilling fluids, nonhazardous waste including cement and oil filters), and hazardous wastes (waste paint or thinners).

The type of discharges included in this permit application allow for the following effluents to be discharged overboard, subject to certain limitations, prohibitions and recordkeeping requirements.

Overboard Discharges

In accordance with NTL 2003-G17, overboard discharges generated by the activities are not required for submittal in this Plan.

Disposed Wastes

The wastes detailed in *Attachment E-1* are those wastes generated by our proposed activities that are disposed of by means of offsite release, injection, encapsulation, or placement at either onshore or offshore permitted locations for the purpose of returning them back to the environment.

Newfield will manifest these wastes prior to being offloaded from the MODU, and transported to shore for disposal at approved sites regulated by the applicable State. Additionally, Newfield will comply with any approvals or reporting and recordkeeping requirements imposed by the State where ultimate disposal will occur.

In accordance with NTL 2003-G17, overboard discharges generated by the activities are not required for submittal in this Plan.

Waste Table

**Attachment E-1
(Public Information)**

Newfield Exploration Company LLC
East Cameron Block 17
Examples of Wastes and Discharges Information

Table 1. Disposal Table (Wastes to be disposed of, not discharged)

Type of Waste Approximate Composition	Amount*	Rate per day	Name/Location of Disposal Facility	Treatment and/or Storage, Transport and Disposal Method
Waste Oil	200 bbl/yr	0.5 bbl/yr	Newpark Environmental Fourchon, LA	Pack in drums and transported to an onshore Incineration site
Norm – contaminated wastes	1 ton	Not applicable	Newpark Environmental Fourchon, LA	Transport to a transfer station via dedicated barge
Trash and debris	1,000 ft ³	3 ft ³ /day	Newpark Environmental Fourchon, LA	Transport in storage bins on crew boat to disposal facility
Chemical product wastes	50 bbl/yr	2 bbl/day	Newpark Environmental Fourchon, LA	Transport in containers to shore location
Chemical product wastes	100 bbl	2 bbl/day	Newpark Environmental Fourchon, LA	Transport in barrels on crew boat to shore location

*can be expressed as a volume, weight, or rate

SECTION F

Oil Spill Response and Chemical Information

A. Regional Oil Spill Response Plan (OSRP) Information

Effective May 20, 2005, Minerals Management Service approved Newfield Exploration Company (Newfield's) Regional Oil Spill Response Plan (OSRP). The most recent modification, dated August 17, 2004 revised Newfield's potential Worse Case Discharge (WCD) for a facility located less than 10 miles from the nearest shoreline. Newfield Exploration Company is the only entity covered under this OSRP. Activities proposed in this Joint Initial and Supplemental Exploration Plan will be covered by the Regional OSRP.

B. Oil Spill Removal Organizations (OSRO)

Newfield utilizes Clean Gulf Associates (CGA) as its primary provider for equipment, which is an industry cooperative owning an inventory of oil spill clean-up equipment. CGA is supported by the Marine Spill Response Corporation's (MSRC), which is responsible for storing, inspecting, maintaining and dispatching CGA's equipment. The MSRC STARS network provides for the closest available personnel, as well as an MSRC supervisor to operate the equipment.

C. Worst-Case Scenario Comparison (WCD)

<i>Category</i>	<i>Current Regional OSRP WCD</i>	<i>Proposed Exploration Plan WCD</i>
Type of Activity	Exploratory	Drilling/Completion/Testing
Facility Surface Location	Green Canyon Block 120	Eugene Island Block 317
Facility Description	MODU	MODU
Distance to Nearest Shoreline (Miles)	87	68
Volume: Storage Tanks (total) Facility Piping (total) Lease Term Pipeline Uncontrolled Blowout (day) Potential 24 Hour Volume (Bbls.)	34,000	10,000
Type of Liquid Hydrocarbon	Crude	Crude
API Gravity	35°	28°

SECTION F

Oil Spill Response and Chemical Information-Continued

Due to the estimated flow rates from an exploratory well blowout are speculative and temporary in nature, Newfield will not modify their Regional OSRP to change the WCD.

Since Newfield has the capability to respond to the worst-case discharge (WCD) spill scenario included in its Regional OSRP approved on May 20, 2005, and since the worst-case scenario determined for our EP does not replace the worst-case scenario in our Regional OSRP, I hereby certify that Newfield has the capability to respond, to the maximum extent practicable, to a worst-case discharge, or a substantial threat of such a discharge, resulting from the activities proposed in our EP.

D. Facility Tanks, Production Vessels

The following table details the *tanks* (capacity greater than 25 bbls. or more) to be used to support the proposed activities (MODU and barges):

Type of Storage Tank	Type of Facility	Tank Capacity (bbls)	Number of Tanks	Total Capacity (bbls)	Fluid Gravity (API)
Fuel Oil	MODU	250	2	500	38° (Diesel)

E. Spill Response Sites

According to NTL 2003-G17, this section of the Plan is not applicable to the proposed operations.

F. Diesel Oil Supply Vessels

According to NTL 2003-G17, this section of the Plan is not applicable to the proposed operations.

G. Support Vessel Fuel Tanks

According to NTL 2003-G17, this section of the Plan is not applicable to the proposed operations.

H. Produced Liquid Hydrocarbon Transportation Vessels

Newfield is proposing to conduct well testing operations on the proposed well locations. This process will include flaring the produced gas hydrocarbons and burning the liquid hydrocarbons.

I. Oil and Synthetic-Based Drilling Fluids

According to NTL 2003-G17, this section of the Plan is not applicable to the proposed operations.

SECTION F

Oil Spill Response and Chemical Information (Continued)

J. Oil Characteristics

According to NTL 2003-G17, this section of the Plan is not applicable to the proposed operations.

K. Blowout Scenario

According to NTL 2003-G17, this section of the Plan is not applicable to the proposed operations.

L. Spill Discussion for NEPA Analysis

According to NTL 2003-G17, this section of the Plan is not applicable to the proposed operations.

M. Pollution Prevention Measures

According to NTL 2003-G17, this section of the Plan is not applicable to the proposed operations.

N. FGBNMS Monitoring Plans

According to NTL 2003-G17, this section of the Plan is not applicable to the proposed operations.

SECTION G

Air Emissions Information

The primary air pollutants associated with OCS exploration activities are:

- Carbon Monoxide
- Particulate Matter
- Sulphur Oxides
- Nitrogen Oxides
- Volatile Organic Compounds

These offshore air emissions result mainly from the drilling rig operations, helicopters, and support vessels. These emissions occur mainly from combustion or burning of fuels and natural gas and from venting or evaporation of hydrocarbons. The combustion of fuels occurs primarily on diesel-powered generators, pumps or motors and from lighter fuel motors. Other air emissions can result from catastrophic events such as oil spills or blowouts.

A. Calculating Emissions

Included as *Attachment G-1* is the Projected Air Quality Emissions Report (Form MMS-138) for Plan Emissions addressing drilling, potential completion and testing operations utilizing a typical jack-up type drilling unit, with related support vessels and construction barge information.

B. Screening Questions

As evidenced by *Attachment G-1*, the worksheets were completed based on which questions responded with a yes.

C. Emission Reduction Measures

The projected air emissions are within the exemption level; therefore, no emission reduction measures are being proposed.

D. Verification of Non-Default Emissions Factors

Newfield has elected to use the default emission factors as provided in *Attachment G-1*.

E. Non-Exempt Activities

The proposed activities are within the exemption amount as provided in *Attachment G-1*.

SECTION G

Air Emissions Information-Continued

F. Review of Activities with Emissions Below the Exemption Level

The proposed activities are below the exemption amount and should not affect the air quality of an onshore area, as provided in *Attachment G-1*.

G. Modeling Report

The proposed activities are below the exemption amount and should not affect the air quality of an onshore area.

Shallow Hazards Lines Transmittal Letter

**Attachment C-5
(Proprietary Information)**

EXPLORATION PLAN (EP)

OMB Control No. 1010-0049
OMB Approval Expires: August 31, 2006

AIR QUALITY SCREENING CHECKLIST

COMPANY	Newfield Exploration Company
AREA	Eugene Island
BLOCK	306/317
LEASE	OCS-G 2109/27120
PLATFORM	
WELL	A,B,C and D
COMPANY CONTACT	Angie Locandro @ R.E.M. Solutions, Inc.
TELEPHONE NO.	(281) 492-8562
REMARKS	Drill, Complete, Test and Mudline Suspend Well Locations A, B, C and D.

Screening Questions for EP's			Yes	No
Is any calculated Complex Total (CT) Emission amount (in tons associated with your proposed exploration activities more than 90% of the amounts calculated using the following formulas: $CT = 3400D^{2/3}$ for CO, and $CT = 33.3D$ for the other air pollutants (where D = distance to shore in miles)?				X
Does your emission calculations include any emission reduction measures or modified emission factors?				X
Are your proposed exploration activities located east of 87.5° W longitude?				X
Do you expect to encounter H ₂ S at concentrations greater than 20 parts per million (ppm)?				X
Do you propose to flare or vent natural gas for more than 48 continuous hours from any proposed well?				X
Do you propose to burn produced hydrocarbon liquids?			X	

Air Pollutant	Plan Emission Amounts ¹ (tons)	Calculated Exemption Amounts ² (tons)	Calculated Complex Total Emission Amounts ³ (tons)
Carbon monoxide (CO)	69.98	56643.69	NA
Particulate matter (PM)	9.01	2264.40	NA
Sulphur dioxide (SO ₂)	43.79	2264.40	NA
Nitrogen oxides (NOx)	304.18	2264.40	NA
Volatile organic compounds (VOC)	9.68	2264.40	NA

¹ For activities proposed in your EP or DOCD, list the projected emissions calculated from the worksheets.

² List the exemption amounts in your proposed activities calculated using the formulas in 30 CFR 250.303(d).

³ List the complex total emissions associated with your proposed activities calculated from the worksheets.

EMISSIONS CALCULATIONS 1ST YEAR

COMPANY	AREA	BLOCK	LEASE	PLATFORM	WELL	CONTACT	PHONE	REMARKS												
Newfield Exploration Company	Eugene Island	308/317	OCS-G 21/09/27	0	A,B,C and D	Angie Loandiro @ R.E.M. Solidif	(281) 492-4562													
OPERATIONS	EQUIPMENT	RATING	MAX. FUEL	ACT. FUEL	RUN TIME	MAXIMUM POUNDS PER HOUR						ESTIMATED TONS								
		HP	GAL/HR	GAL/D																
		MMBTU/HR	SCF/HR	SCF/D	HR/D	DAYS	PM	SOx	NOx	VOC	CO	PM	SOx	NOx	VOC	CO				
DRILLING	Diesel Engines																			
	Nat. Gas Engines																			
	Barriers																			
	PRIME MOVER>600hp diesel	11400	550.62	13214.88	24	82	8.04	36.86	276.21	8.29	60.26	7.91	36.27	271.79	8.15	59.30				
	PRIME MOVER>600hp diesel	0	0	0.00	0	0	0.00	0.00	0.00	0.00	0.00	0.00	0.00	0.00	0.00	0.00				
	PRIME MOVER>600hp diesel	0	0	0.00	0	0	0.00	0.00	0.00	0.00	0.00	0.00	0.00	0.00	0.00	0.00				
	PRIME MOVER>600hp diesel	0	0	0.00	0	0	0.00	0.00	0.00	0.00	0.00	0.00	0.00	0.00	0.00	0.00				
FACILITY INSTALLATION	BURNER diesel	0			0	0	0.00	0.00	0.00	0.00	0.00	0.00	0.00	0.00	0.00	0.00				
	AUXILIARY EQUIP<600hp diesel	0	0	0.00	0	0	0.00	0.00	0.00	0.00	0.00	0.00	0.00	0.00	0.00	0.00				
	VESSELS>600hp diesel(crew)	2065	99.7395	2393.75	8	36	1.46	6.68	50.03	1.50	10.92	0.21	0.96	7.20	0.22	1.57				
	VESSELS>600hp diesel(supply)	2065	99.7395	2393.75	10	60	1.46	6.68	50.03	1.50	10.92	0.44	2.00	15.01	0.45	3.27				
	VESSELS>600hp diesel(tugs)	4200	202.86	4868.64	12	3	2.96	13.58	101.76	3.05	22.20	0.05	0.24	1.83	0.05	0.40				
DRILLING WELL TEST	DERRICK BARGE diesel	0	0	0.00	0	0	0.00	0.00	0.00	0.00	0.00	0.00	0.00	0.00	0.00	0.00				
	MATERIAL TUG diesel	0	0	0.00	0	0	0.00	0.00	0.00	0.00	0.00	0.00	0.00	0.00	0.00	0.00				
	VESSELS>600hp diesel(crew)	0	0	0.00	0	0	0.00	0.00	0.00	0.00	0.00	0.00	0.00	0.00	0.00	0.00				
	VESSELS>600hp diesel(supply)	0	0	0.00	0	0	0.00	0.00	0.00	0.00	0.00	0.00	0.00	0.00	0.00	0.00				
2006 YEAR TOTAL	MISC.	BPD	SCF/HR	COUNT																
	TANK-	0			0	0				0.00					0.00					
	OIL BURN	250			24	4	4.38	71.15	20.83	0.10	2.19	0.21	3.42	1.00	0.00	0.11				
2006 YEAR TOTAL	GAS FLARE		208333.33		24	4		0.12	14.87	12.56	80.94		0.01	0.71	0.60	3.88				
							18.28	135.07	513.75	27.01	187.42	8.82	42.90	297.55	9.48	68.54				
EXEMPTION CALCULATION	DISTANCE FROM LAND IN MILES															2264.40	2264.40	2264.40	2264.40	56643.69
	68.0																			

EMISSIONS CALCULATIONS 2ND YEAR

COMPANY	AREA	BLOCK	LEASE	PLATFORM	WELL	CONTACT	PHONE	REMARKS
Newfield Exploration Company	Eugene Island	306317	OCS-G 2108/22	0	A,B,C and D	Angle Loandoro @ R.E.M. Solati	(281) 492-5552	
OPERATIONS								
EQUIPMENT						MAXIMUM POUNDS PER HOUR		
PRIME MOVER-600hp diesel						ESTIMATED TONS		
PRIME MOVER-600hp diesel								
PRIME MOVER-600hp diesel								
PRIME MOVER-600hp diesel								
BURNER diesel								
AUXILIARY EQUIP<600hp diesel								
VESSELS>600hp diesel(crew)								
VESSELS>600hp diesel(supply)								
VESSELS>600hp diesel(tugs)								
DERRICK BARGE diesel								
MATERIAL TUG diesel								
VESSELS>600hp diesel(crew)								
VESSELS>600hp diesel(supply)								
MISC.								
TANK-								
OIL BURN								
GAS FLARE								
2007 YEAR TOTAL								
DISTANCE FROM LAND IN MILES								
68.0								
EXEMPTION CALCULATION								
						2264.40	2264.40	2264.40
						9.01	43.79	304.18
						27.01	187.42	9.68
						69.98		
						56643.89		

SUMMARY

COMPANY	AREA	BLOCK	LEASE	PLATFORM	WELL
Newfield Exploration Company	Eugene Island	306/317	OCS-G 2109/27120	0	A,B,C and D
Year	Emitted		Substance		
	PM	SOx	NOx	VOC	CO
2006	8.82	42.90	297.55	9.48	68.54
2007	9.01	43.79	304.18	9.68	69.98
Allowable	2264.40	2264.40	2264.40	2264.40	56643.69

SECTION H

Environmental Impact Analysis

A. IMPACT PRODUCING FACTORS (IPF'S)

The following matrix is utilized to identify the environmental resources that could be impacted by these IPF's. An "x" has been marked for each IPF category that Newfield has determined may impact a particular environmental resource as a result of the proposed activities. For those cells which are footnoted, a statement is provided as to the applicability of the proposed activities, and where there may be an effect, an analysis of the effect is provided.

Environmental Resources	Emissions (air, noise, light, etc.)	Effluents (muds, cuttings, other discharges to the water column or seafloor	Physical Disturbances To the seafloor (rig or anchor emplacement, etc.)	Wastes Sent to Shore for Treatment Or disposal	Accidents (e.g. oil spills, chemical spills, H2S releases)	Other IPF's identified
Site Specific at Offshore Location						
Designated topographic feature						
Pinnacle Trend area live bottoms						
Eastern Gulf live bottoms						
Chemosynthetic communities						
Water quality		X			X	
Fisheries		X			X	
Marine mammals	X	X			X	
Sea turtles	X	X			X	
Air quality	X					
Shipwreck sites (known or potential)						
Prehistoric archaeological sites						
Vicinity of Offshore Location						
Essential fish habitat					X	
Marine and pelagic birds					X	
Public health and safety						
Coastal and Onshore						
Beaches					X	
Wetlands					X	
Shorebirds and coastal nesting birds					X	
Coastal wildlife refuges					X	
Wilderness areas					X	
Other Resources						

SECTION H

Environmental Impact Analysis-Continued

B. VICINITY OF OFFSHORE LOCATION ANALYSES

1. Designated Topographic Features

There are no anticipated effluents, physical disturbances to the seafloor, and accidents from the proposed activities that could cause impacts to topographic features. The proposed surface disturbances within Eugene Island Block 317 are located approximately 6 miles away from the closest designated topographic feature (Fishnet Bank). The crests of designated topographic features in the northern Gulf are found below 10 m. In the event of an accidental oil spill from the proposed activities, the gravity of such oil (high gravity condensate and/or diesel fuel) would rise to the surface, quickly dissipate, and/or be swept clear by the currents moving around the bank; thereby avoiding the sessile biota.

2. Pinnacle Trend Live Bottoms

There are no anticipated effluents, physical disturbances to the seafloor, and accidents from the proposed activities that could cause impacts to a pinnacle trend area. The proposed surface disturbances within Eugene Island Block 37 are located a significant distance (>100 miles) from the closest pinnacle trend live bottom stipulated block. The crests of the pinnacle trend area are much deeper than 20 m. In the event of an accidental oil spill from the proposed activities, the gravity of such oil (high gravity condensate and/or diesel fuel) would rise to the surface, quickly dissipate, and/or be swept clear by currents moving around the bank; and thus not impacting the pinnacles.

3. Eastern Gulf Live Bottoms

There are no anticipated effluents, physical disturbances to the seafloor, and accidents from the proposed activities that could cause impacts to Eastern Gulf live bottoms. The proposed surface disturbances within Eugene Island Block 317 are located a significant distance (>100 miles) from the closest pinnacle Eastern Gulf live bottom stipulated block. In the event of an accidental oil spill from the proposed activities, the gravity of such oil (high gravity condensate and/or diesel fuel) would rise to the surface, quickly dissipate, and/or be swept clear by currents moving around the bank; and would not be expected to cause adverse impacts to Eastern Gulf live bottoms because of the depth of the features and dilutions of spills.

4. Chemosynthetic Communities

Water depths at the surface location in Eugene Island Block 317 range from 232 feet to 242 feet. Therefore, the proposed activities are not located within the vicinity of any known chemosynthetic communities, which typically occur in water depths greater than 400 meters.

SECTION H

Environmental Impact Analysis-Continued

5. Water Quality

Accidental oil spill releases from the proposed activities, and cumulative similar discharge activity within the vicinity could potentially cause impacts to water quality. It is unlikely that an accidental oil spill release would occur from the proposed activities. In the event of such a release, the water quality would be temporarily affected by the dissolved components and small droplets. Currents and microbial degradation would remove the oil from the water column or dilute the constituents to background levels.

In the event of an unanticipated blowout resulting in an oil spill, it is unlikely to have an impact based on the industry wide standards for using proven equipment and technology for such responses, implementation of Newfield's Regional Oil Spill Response Plan which address available equipment and personnel, techniques for containment and recovery, and removal of the oil spill. Newfield will conduct the proposed activities under EPA's Region VI NPDES General Permit GMG290000 which authorizes the discharge of certain effluents, subject to certain limitations, prohibitions and recordkeeping requirements. As such, it is not anticipated these discharges will cause significant adverse impacts to water quality.

6. Fisheries

Accidental oil spill releases from the proposed activities, and cumulative similar discharge activity within the vicinity may potentially cause some detrimental effects on fisheries. It is unlikely a spill would occur; however, such a release in open waters closed to mobile adult finfish or shellfish would likely be sublethal and the extent of damage would be reduced to the capability of adult fish and shellfish to avoid a spill, to metabolize hydrocarbons, and to excrete both metabolites and parent compounds.

In the event of an unanticipated blowout resulting in an oil spill, it is unlikely to have an impact based on the industry wide standards for using proven equipment and technology for such responses, implementation of Newfield's Regional Oil Spill Response Plan which address available equipment and personnel, techniques for containment and recovery, and removal of the oil spill. Newfield will conduct the proposed activities under EPA's Region VI NPDES General Permit GMG290000 which authorizes the discharge of certain effluents, subject to certain limitations, prohibitions and recordkeeping requirements. As such, it is not anticipated these discharges will cause significant adverse impacts to water quality.

7. Marine Mammals

As a result of the proposed activities, marine mammals may be adversely impacted by traffic, noise, accidental oil spills, cumulative similar discharge activity, and loss of trash and debris.

SECTION H

Environmental Impact Analysis-Continued

Chronic and sporadic sublethal effects could occur that may stress and/or weaken individuals of a local group or population and make them more susceptible to infection from natural or anthropogenic sources. Few lethal effects are expected from accidental oil spill, chance collisions with service vessels and ingestion of plastic material.

The net results of any disturbance would depend on the size and percentage of the population affected, ecological importance of the disturbed area, environmental and biological parameters that influence an animal's sensitivity to disturbance and stress, and the accommodation time in response to prolonged disturbance (Geraci and St. Aubin, 1980). Collisions between cetaceans and ship could cause serious injury or death (Laist et al., 2001). Sperm whales are one of 11 whale species that are hit commonly by ships (Laist et al., 2001). Collisions between OCS vessels and cetaceans within the project area are expected to be unusual events.

In the event of an unanticipated blowout resulting in an oil spill, it is unlikely to have an impact based on the industry wide standards for using proven equipment and technology for such responses, implementation of Newfield's Regional Oil Spill Response Plan which address available equipment and personnel, techniques for containment and recovery, and removal of the oil spill. Newfield will conduct the proposed activities under EPA's Region VI NPDES General Permit GMG290000 which authorizes the discharge of certain effluents, subject to certain limitations, prohibitions and recordkeeping requirements. As such, it is not anticipated these discharges will cause significant adverse impacts to water quality. Additionally, Newfield and its contractors will conduct the proposed activities under the additional criteria addressed by MMS in Notice to Lessee's (NTL's) 2003-G10 "Vessel Strike Avoidance and Injured/Dead Protective Species" and NTL 2003-G11 "Marine Trash & Debris Awareness & Elimination".

8. Sea Turtles

As a result of the proposed activities, sea turtles may be adversely impacted by traffic, noise, accidental oil spills, cumulative similar discharges, and loss of trash and debris. Small numbers of turtles could be killed or injured by chance collision with service vessels or by eating indigestible trash, particularly plastic items accidentally lost from drilling rigs, production facilities and service vessels. Drilling rigs and project vessels (construction barges) produce noise that could disrupt normal behavior patterns and crease some stress to sea turtles, making them more susceptible to disease. Accidental oil spill releases are potential threats which could have lethal effects on turtles. Contact and/or consumption of this released material could seriously affect individual sea turtles. Most OCS related impacts on sea turtles are expected to be sublethal. Chronic and/or avoidance of effected areas could cause declines in survival or productivity, resulting in gradual population declines.

SECTION H

Environmental Impact Analysis-Continued

In the event of an unanticipated blowout resulting in an oil spill, it is unlikely to have an impact based on the industry wide standards for using proven equipment and technology for such responses, implementation of Newfield's Regional Oil Spill Response Plan which address available equipment and personnel, techniques for containment and recovery, and removal of the oil spill. Newfield will conduct the proposed activities under EPA's Region VI NPDES General Permit GMG290000 which authorizes the discharge of certain effluents, subject to certain limitations, prohibitions and recordkeeping requirements.

As such, it is not anticipated these discharges will cause significant adverse impacts to water quality. Additionally, Newfield and its contractors will conduct the proposed activities under the additional criteria addressed by MMS in Notice to Lessee's (NTL's) 2003-G10 "Vessel Strike Avoidance and Injured/Dead Protective Species" and NTL 2003-G11 "Marine Trash & Debris Awareness & Elimination".

9. Air Quality

The proposed activities are located approximately 68 miles to the nearest shoreline. There would be a limited degree of air quality degradation in the immediate vicinity of the proposed activities. Air quality analyses of the proposed activities are below the MMS exemption level.

10. Shipwreck Site (Known or Potential)

There are no physical disturbances to the seafloor which could impact known or potential shipwreck sites, as the review of high resolution shallow hazards data indicate there are no known or potential shipwreck sites located within the surveyed area.

11. Prehistoric Archaeological Sites

There are no physical disturbances to the seafloor which could cause impacts to prehistoric archaeological sites, as the review of high resolution shallow hazards data and supporting studies did not reflect the occurrence of prehistoric archaeological sites.

Site Specific Offshore Location Analyses

1. Essential Fish Habitat

An accidental oil spill that may occur as a result of the proposed activities has potential to cause some detrimental effects on essential fish habitat. It is unlikely that an accidental oil spill release would occur; however, if a spill were to occur in close proximity to finfish or shellfish, the effects would likely be sublethal and the extent of damage would be reduced to the capability of adult fish and shellfish to avoid a spill, to metabolize hydrocarbons, and to excrete both metabolites and parent compounds.

SECTION H

Environmental Impact Analysis-Continued

In the event of an unanticipated blowout resulting in an oil spill, it is unlikely to have an impact based on the industry wide standards for using proven equipment and technology for such responses, implementation of Newfield's Regional Oil Spill Response Plan which address available equipment and personnel, techniques for containment and recovery, and removal of the oil spill.

2. Marine and Pelagic Birds

An accidental oil spill that may occur as a result of the proposed activities has potential to impact marine and pelagic birds, by the birds coming into contact with the released oil. It is unlikely that an accidental oil spill release would occur.

In the event of an unanticipated blowout resulting in an oil spill, it is unlikely to have an impact based on the industry wide standards for using proven equipment and technology for such responses, implementation of Newfield's Regional Oil Spill Response Plan which address available equipment and personnel, techniques for containment and recovery, and removal of the oil spill.

3. Public Health and Safety Due to Accidents

There are no anticipated IPF's from the proposed activities that could impact the public health and safety. Newfield has requested MMS approval to classify the proposed objective area as absent of hydrogen sulfide.

Coastal and Onshore Analyses

1. Beaches

An accidental oil spill release from the proposed activities could cause impacts to beaches. However, due to the distance from shore (approximately 68 miles), and the response capabilities that would be implemented, no significant adverse impacts are expected. Both historical spill data and the combined trajectory/risk calculations referenced in the publication of OCS EIA /EA MMS 2002-052 indicate there is little risk of contact or impact to the coastline and associated environmental resources.

In the event of an unanticipated blowout resulting in an oil spill, it is unlikely to have an impact based on the industry wide standards for using proven equipment and technology for such responses, implementation of Newfield's Regional Oil Spill Response Plan which address available equipment and personnel, techniques for containment and recovery, and removal of the oil spill.

SECTION H

Environmental Impact Analysis-Continued

2. Wetlands

An accidental oil spill release from the proposed activities could cause impacts to wetlands. However, due to the distance from shore (approximately 68 miles) and the response capabilities that would be implemented, no significant adverse impacts are expected. Both historical spill data and the combined trajectory/risk calculations referenced in the publication of OCS EIA /EA MMS 2002-052 indicate there is little risk of contact or impact to the coastline and associated environmental resources.

In the event of an unanticipated blowout resulting in an oil spill, it is unlikely to have an impact based on the industry wide standards for using proven equipment and technology for such responses, implementation of Newfield's Regional Oil Spill Response Plan which address available equipment and personnel, techniques for containment and recovery, and removal of the oil spill.

3. Shore Birds and Coastal Nesting Birds

An accidental oil spill release from the proposed activities could cause impacts to shore birds and coastal nesting birds. However, due to the distance from shore (approximately 68 miles) and the response capabilities that would be implemented, no significant adverse impacts are expected. Both historical spill data and the combined trajectory/risk calculations referenced in the publication of OCS EIA /EA MMS 2002-052 indicate there is little risk of contact or impact to the coastline and associated environmental resources.

In the event of an unanticipated blowout resulting in an oil spill, it is unlikely to have an impact based on the industry wide standards for using proven equipment and technology for such responses, implementation of Newfield's Regional Oil Spill Response Plan which address available equipment and personnel, techniques for containment and recovery, and removal of the oil spill.

4. Coastal Wildlife Refuges

An accidental oil spill release from the proposed activities could cause impacts to coastal wildlife refuges. However, due to the distance from shore (approximately 68 miles) and the response capabilities that would be implemented, no significant adverse impacts are expected. Both historical spill data and the combined trajectory/risk calculations referenced in the publication of OCS EIA /EA MMS 2002-052 indicate there is little risk of contact or impact to the coastline and associated environmental resources.

In the event of an unanticipated blowout resulting in an oil spill, it is unlikely to have an impact based on the industry wide standards for using proven equipment and technology for such responses, implementation of Newfield's Regional Oil Spill Response Plan which

SECTION H

Environmental Impact Analysis-Continued

address available equipment and personnel, techniques for containment and recovery, and removal of the oil spill.

5. Wilderness Areas

An accidental oil spill release from the proposed activities could cause impacts to wilderness areas. However, due to the distance from shore (approximately 68 miles) and the response capabilities that would be implemented, no significant adverse impacts are expected. Both historical spill data and the combined trajectory/risk calculations referenced in the publication of OCS EIA /EA MMS 2002-052 indicate there is little risk of contact or impact to the coastline and associated environmental resources.

In the event of an unanticipated blowout resulting in an oil spill, it is unlikely to have an impact based on the industry wide standards for using proven equipment and technology for such responses, implementation of Newfield's Regional Oil Spill Response Plan which address available equipment and personnel, techniques for containment and recovery, and removal of the oil spill.

Other Identified Environmental Resources

Newfield has not identified any other environmental resources other than those addressed above.

Impacts on Proposed Activities

No impacts are expected on the proposed activities as a result of taking into consideration the site specific environmental conditions.

A High Resolution Shallow Hazards Survey was conducted, a report prepared in accordance with NTL 98-20.

Based on the analysis of the referenced data, there are no surface or subsurface geological and manmade features and conditions that may adversely affect the proposed activities. Newfield will institute procedures to avoid pipelines and abandoned wells within the vicinity of the proposed operations.

Alternatives

Newfield did not consider any alternatives to reduce environmental impacts as a result of the proposed activities.

SECTION H

Environmental Impact Analysis-Continued

Mitigation Measures

Newfield will not implement any mitigation measures to avoid, diminish, or eliminate potential environmental resources, other than those required by regulation and policy.

Consultation

Newfield has not contacted any agencies or persons for consultation regarding potential impacts associated with the proposed activities. Therefore, a list of such entities is not being provided.

References

The following documents were utilized in preparing the Environmental Impact Assessment:

<i>Document</i>	<i>Author</i>	<i>Dated</i>
Shallow Hazards Survey	Gulf Ocean	1999
MMS Environmental Impact Statement Report No. 2002-15	Minerals Management Service	2002
NTL 2003-N06 "Supplemental Bond Procedures"	Minerals Management Service	2003
NTL 2004-G01 "Implementation of Seismic Survey Mitigation Measures and Protected Species Observer Program"	Minerals Management Service	2004
NTL 2003-G10 "Vessel Strike Avoidance and Injured/Dead Protective Species"	Minerals Management Service	2003
NTL 2003-G11 "Marine Trash & Debris Awareness & Elimination"	Minerals Management Service	2003
NTL 2002-G09 "Regional and Subregional Oil Spill Response Plans"	Minerals Management Service	2002
NTL 2003-G17 "Guidance for Submitting Exploration Plans and Development Operations Coordination Documents"	Minerals Management Service	2003
NTL 2005-G07 "Archaeological Resource Surveys and Reports"	Minerals Management Service	2005
NTL 2000-G16 "Guidelines for General Lease Surety Bonds"	Minerals Management Service	2000
NTL 98-20 "Shallow Hazards Survey Requirements"	Minerals Management Service	1998
NTL 98-16 "Hydrogen Sulfide Requirements"	Minerals Management Service	1998
NPDES General Permit GMG290000	EPA - Region VI	2004
Regional Oil Spill Response Plan	Newfield Exploration Company	2005

SECTION I

CZM Consistency

Under direction of the Coastal Zone Management Act (CMZA), the States of Alabama, Florida, Louisiana, Mississippi and Texas developed Coastal Zone Management Programs (CZMP) to allow for the supervision of significant land and water use activities that take place within or that could significantly impact their respective coastal zones.

A certificate of Coastal Zone Management Consistency for the State of Louisiana is enclosed as *Attachment I-1*.

Newfield Exploration Company has considered all of Louisiana's enforceable policies and certifies the consistency for the proposed operations.

Louisiana CZM Statement

**Attachment I-1
(Public Information)**

COASTAL ZONE MANAGEMENT CONSISTENCY CERTIFICATION

JOINT INITIAL AND SUPPLEMENTAL EXPLORATION PLAN

EUGENE ISLAND BLOCKS 306/317

LEASEs OCS-G 02109/27120

The proposed activities described in detail in the enclosed Plan comply with Louisiana's approved Coastal Zone Management Program and will be conducted in a manner consistent with such Program.

By: Newfield Exploration Company LLC

Signed By: *Abbi Winters*

Dated: 9/19/05