

G-5998

In Reply Refer To: RP-2-1

APR 20 1984

Anadarko Production Company
Attention: Mr. Robert L. Sims
15801 Greenspoint Park Drive
Houston, Texas 77060

Gentlemen:

Reference is made to your Initial Plan of Exploration received February 29, 1984, amended April 6, 11, and 19, 1984, for Lease OCS-G 5998, Block 788, Mustang Island Area. This plan includes the activities proposed for Wells A, B, C, and D.

In accordance with 30 CFR 250.34, revised December 13, 1979, and our letter dated January 29, 1979, this plan has been determined to be complete as of April 20, 1984, and is now being considered for approval.

Your plan control number is N-1577 and should be referenced in your communication and correspondence concerning this plan.

Sincerely yours,

(Orig. Sgd.) D.W. Solanas

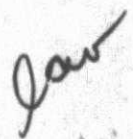

D. W. Solanas
Regional Supervisor
Rules and Production

bcc: Lease OCS-G 5998 (OPS-4) (FILE ROOM)
OPS-4 w/Public Info. Copy of the plan (PUBLIC RECORDS ROOM)
00-3

WWilliamson:gtj:4/12/84 Disk 3a

Office of
Production

MAY 10 1984

Records Management
Section



RONALD A. BAIN
DIVISION EXPLORATION MANAGER
OFFSHORE

November 15, 1983

United States Department
U. S. Geological Survey
P. O. Box 7944
Metairie, LA 70010

PUBLIC INFORMATION COPY

Attention: Mr. Emil Simoneaux
Area Oil and Gas Supervisor

Re: Plan of Exploration
OCS-G-5998 Block 788
Mustang Island

Gentlemen:

Block 788 was a tract purchased in the Federal OCS Sale No. 74 held on August 24, 1983 for a lease bonus of \$3,355,000.

The participants in that purchase are:

Block 788	Anadarko Production Company	31.25%
	Champlin Petroleum Company	31.25%
	Williams Exploration Company	12.50%
	Energy Development Company	12.50%
	Pioneer Exploration Company	12.50%

Anadarko Production Company is the designated operator for the block. Consequently, we are submitting the enclosed Plan of Exploration for your approval so that we may evaluate this lease expeditiously.

Four well locations are proposed in the Plan of Exploration and described in Section One, accompanied by:

- (a) A location map showing the lease block relative to the shoreline and onshore support-base facilities.
- (b) A map showing the location of the (four) proposed wells.
- (c) One seismic structure map (Rob L - Rob M).

A preliminary construction hazards and archeological report in letter form will be forthcoming from COMAP Geosurveys, Incorporated by December 31, 1983. The complete report prepared by COMAP will be sent under separate cover to Mr. Emil Simoneaux of the U.S.G.S. and Mr. Rankin of the BLM.

Plan of Exploration
OCS-G-5998 Block 788
Mustang Island

-2-

November 15, 1983

PUBLIC INFORMATION COPY

Anadarko Production Company's base of operations (Port O'Connor) is within a 12 hour drive from oil spill containment equipment (Clean Gulf Associates). Anadarko Production Company has an Oil Field Contingency Plan currently in your files. Also included is a list of mud additives and components that could be used in the drilling program.

Exploration and any future production activity within the Mustang Island 788 area will be conducted in a manner consistent with state and Federal requirements for coastal zone operations. The activities associated with this plan will be executed in compliance with all OCS orders and memoranda, and any required permits will be filed in a timely manner.

Anadarko, as an operator in the Gulf of Mexico and a member of the Clean Gulf Associates with the approved Oil Spill Contingency Plan on file with the U.S.G.S., intends to exercise all diligence toward protection of the environment while implementing this Plan of Exploration.

Very truly yours,

ANADARKO PRODUCTION COMPANY

Ronald A. Bain

Ronald A. Bain
Exploration Manager
Offshore Division

JBH:bld
Enclosure

PLAN OF EXPLORATION - MUSTANG ISLAND BLOCK, 788

Schedule of Drilling Activity

- Block 788 #A - Surface location 1200' FNL and 1300' FEL Mustang Island Block 788. BHL same. PTD 10000'.
- Block 788 #B - Surface location 4500' FNL and 5250' FEL Mustang Island Block 788. BHL same. PTD 10000'.
- Block 788 #C - Surface location 11000' FNL and 7900' FEL Mustang Island Block 788. BHL same. PTD 10000'.
- Block 788 #D - Surface location 500' FNL and 500' FEL Mustang Island Block 788. BHL same. PTD 10000'.

The initial well (expected to be 788 #A) will be spudded as soon as permits are approved and a jack-up rig is available, which should be in the first quarter of 1984. It is expected to take an average of approximately 45 days to drill and complete a well. Upon drilling and evaluating the results of our first well, a decision would be made concerning the drillability of the remaining three locations.

Any of the four drillsites could be completed and suspended with a template set over the wells for later development into a platform location.

BEST
AVAILABLE
COPY

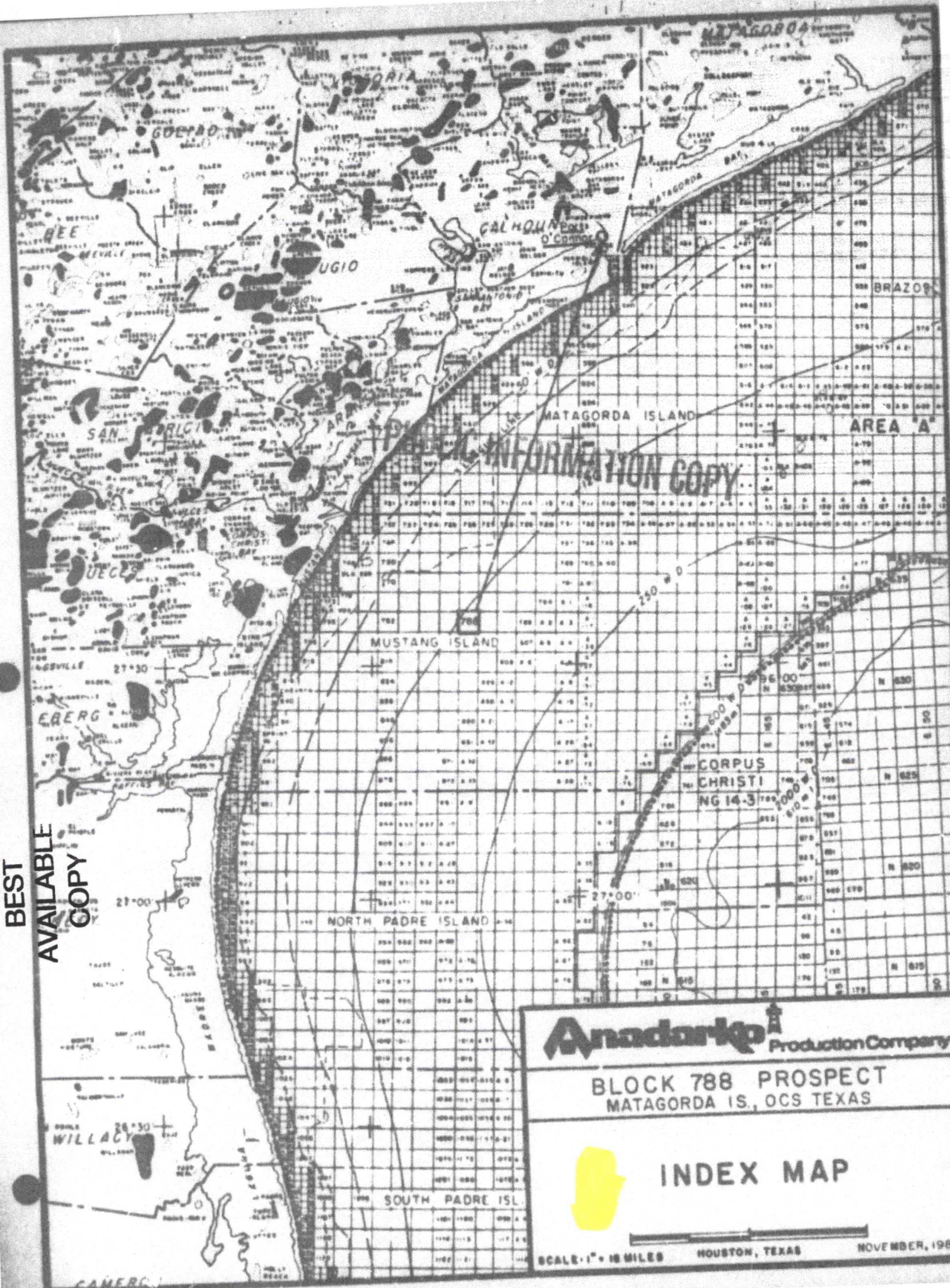

Anadarko Production Company

BLOCK 788 PROSPECT
MATAGORDA IS., OCS TEXAS

INDEX MAP

SCALE 1" = 10 MILES
HOUSTON, TEXAS
NOVEMBER, 1963

779

780

781

PUBLIC INFORMATION COPY

789

788

ANADARKO
OCS 5998

787

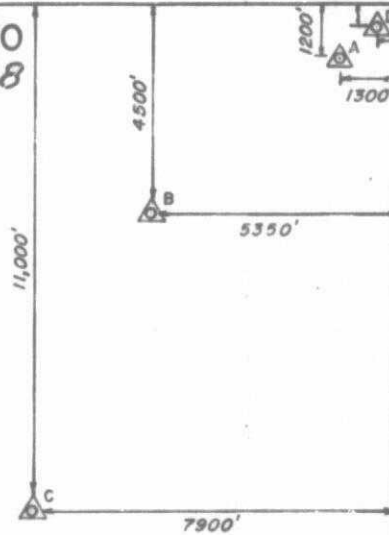

803

804

805

Anadarko Production Company

MUSTANG ISLAND BLK. 788
OCS TEXAS

PLAN OF EXPLORATION

4000' 0 4000'

HOUSTON, TEXAS

SITE SPECIFIC SHALLOW HAZARDS
REPORT AND ARCHAEOLOGICAL ASSESSMENT

MINERAL MANAGEMENT SERVICE

MUSTANG ISLAND 788
OFFSHORE TEXAS

APR 19 1984

RULES AND PRODUCTION

The four proposed drill sites are as follows:

Blk. 788 "A" - 1200' FNL, 1300' FEL

Blk. 788 "C" - 11000' FNL, 7900' FEL

Blk. 788 "B" - 4500' FNL, 5350' FEL

Blk. 788 "D" - 500' FNL, 500' FEL

During January, 1984, Comap Geosurveys Inc. conducted a high resolution geo-hazards survey of Mustang Island 788 for Anadarko Production Company. The survey included side-scan sonar, sub-bottom profiler, magnetometer, fathometer, single trace analog and 12 fold digital seismic recordings with an 8 KJ sparker as the energy source. Copies of the final report were submitted to Mr. Solanas of the M.M.S.

The marine archaeological assessment of the data gathered concludes that there is no evidence of cultural resources which might be affected by oil and gas exploration in the area. The only magnetic anomaly noted relates to an abandoned well site and will be avoided in future operations.

An Anadarko geophysicist has examined the data gathered by Comap and made the following observations:

Water depths range from about 120' to 140' with the seafloor sloping gently to the southeast at about 3-4 ft. per mile.

Side-scan sonar reveals numerous small pock marks but no other significant features on the seafloor.

A single magnetic anomaly was noted in the north central portion of the block, well removed from any planned exploratory activity.

Sub-bottom profiler and sparker data suggest N-S channeling and shallow gas in several areas. Locations "A", "B" and "D" are at least 3000' from any of these features and location "C" is approximately 1000' from a meander in the channel.

Flat lying, uninterrupted seismic events exhibited by processed and analog sparker data indicate the four locations included in the plan to be free of faulting to depths of at least 3000'.

In conclusion, high resolution data gathered by Comap in Mustang Island 788 suggests that oil and gas exploration can be conducted in the area with little chance of damage to cultural resources. The data further suggests that the four locations selected are free of shallow gas and or faulting or seafloor features which might constitute a drilling or construction hazard.

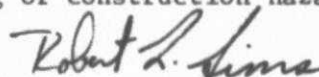

Robert L. Sims
Geophysical Advisor
Anadarko Production Company
April 16, 1984

JU-200MC

Mat-supported cantilever jack-up drill rig

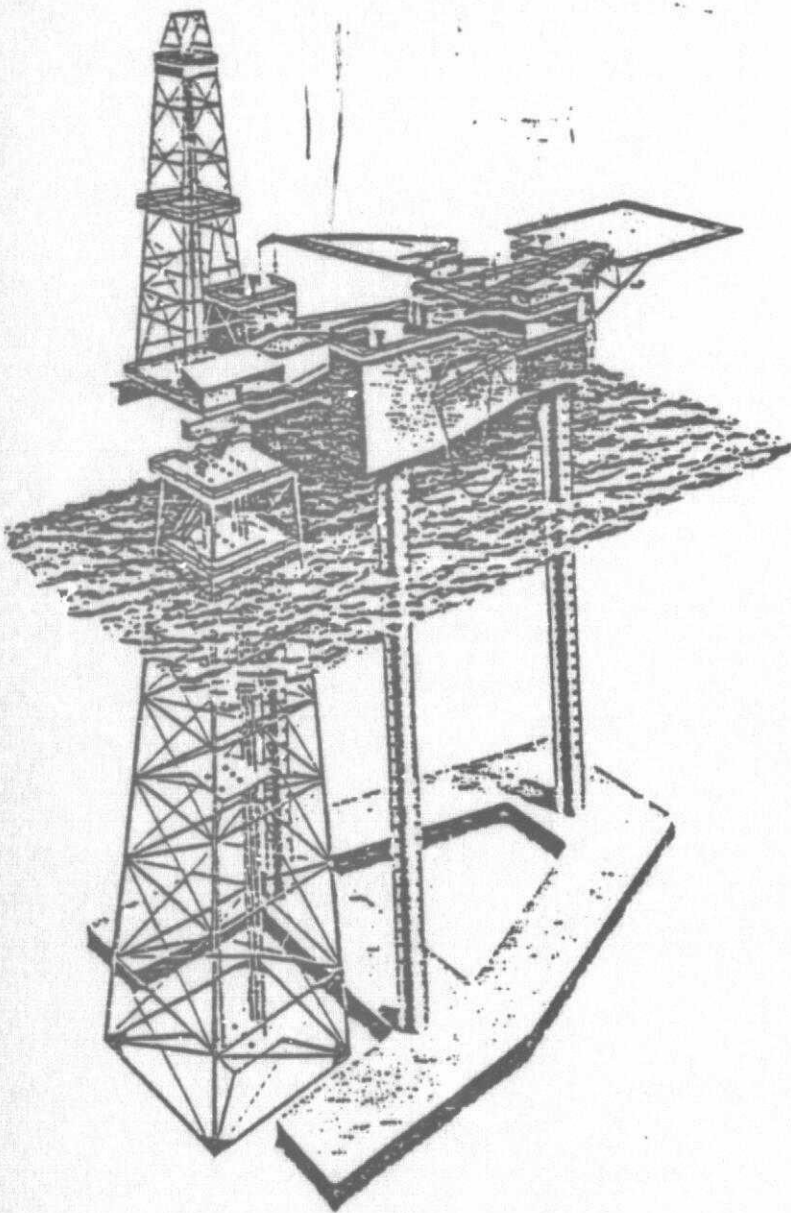

The JU-200MC in operating position. Cantilever feature can place rotary as far as 45 feet astern of platform.

JU-200MC		
Nominal Dimensions		
Platform	457' x 132' x 18'	
Mat	220' x 185' x 10' + 2' Skirt	
Slot	59'8" x 110' wide	
Columns (3)	11' OD x 269' long	
Nominal Capacities		
Max. Variable Loads:		
Drilling	2,250 tons	
Moving (23' Nom. Draft)	1,250 tons	
Moving (11'6" Draft)	350 tons	
Drilling Water	5,900 bbl	
Fuel Oil	2,000 bbl	
Potable Water	1,000 bbl	
Liquid Mud	1,500 bbl	
Bulk Mud & Cement	6,000 cu ft	
Bag Storage	3,000 sacks	
Pipe Rack Area	3,000 sq ft	
Quarters	51 pers	
Skidable Substructure for 1,390,000-lb Demck		
Design Operating Conditions		
Min. Maneuvering Depth: 11'6"		
	Hurricane @ 175 ft	Non- Hurricane @ 200 ft
Max. Still Water Depth		
Max. Wave Height	60 ft	33 ft
Wave Period	15 sec	10 sec
Design Wind Velocity	100 kts	70 kts
Min. Air Gap	45 ft	26 ft

Bethlehem's series of cantilever jack-up drilling rig designs include the mat-supported JU-200MC (to 200' water depths), JU-150MC (150' waters) and the JU-100MC (100' waters).

Bethlehem



Bethlehem Steel—Shipbuilding

Beaumont Yard: P.O. Box 3031, Beaumont, TX 77704 · Call: (713) 838-6821 · Telex: 77-9441 · Cables: BETHSHIP New York
 Bethlehem Singapore Pte. Ltd.: P.O. Box 41, Sempawang Post Office, Singapore 9175 · Call: 257-4745 · Telex: R521770 (BETHPOR) · Cables: BETHSING Singapore
 Executive and General Sales: Martin Tower, Bethlehem, PA 18016 · Call: (215) 694-3763



MINERALS MANAGEMENT SERVICE

April 3, 1984

APR 06 1984

RULES AND PRODUCTION

U. S. Department of the Interior
Minerals Management Service
P. O. Box 7944
Metairie, Louisiana 70010

Attention: Mr. Emil Simoneaux

RE: Site Specific Report
Location A: 1,300' FEL, 1,200' FNL
Mustang Island Block 788
Plan Control No. 1577

Dear Sir:

With this letter, we are sending nine (9) copies of the above referenced Site Specific Report for inclusion with the Plans of Exploration previously submitted. The complete Hazards Survey Report with Archaeological Assessment was submitted under separate cover.

The field data gathered by Comap have been examined and found to be of good quality. In the area of current interest i.e. Location "A" we concur with Comap's findings. Nothing in the data suggests the presence of sea-floor irregularities, shallow faulting or gas that might constitute a drill or construction hazard in the vicinity of the proposed "A" location.

Yours truly,

ANADARKO PRODUCTION COMPANY

Robert L. Sims
Geophysical Advisor
Offshore Division

RLS/cb

Enclosure

PLAN OF EXPLORATION

MUSTANG ISLAND AREA
BLOCK 788

OCS-G-5998

DESCRIPTION OF DRILLING RIG

The attached schematic and specifications sheet describe the type of drilling rig Anadarko anticipates using to drill the wells in the Plan of Exploration. The specific rig which will be utilized is similar to the JU-200 MC.

PLAN OF EXPLORATION

MUSTANG ISLAND AREA
BLOCK 788

OCS-G-5998

MUD ADDITIVES

The attached list of mud additives is anticipated to be used in drilling the wells outlined in this Plan of Exploration.

Chapter 23

COMPARABLE MUD PRODUCTS BY TRADENAMES

Description	IMCO SERVICES	Baroid	Magco	Milchem	Primary Application
WEIGHTING AGENTS AND VISCOSIFIERS					
Barite	IMCO BAR	Baroid	Magco	Mil-Bar	For increasing mud weight up to 20 ppg.
Calcium Carbonate	IMCO WATE		Lu-Wate	W.O. 30 W.O. 50	For increasing weight of oil muds up to 10.8 ppg.
Bentonite	IMCO GEL	Aquagel	Magco	Milgel	Viscosity and filtration control in water base muds.
Sub-Bentonite	IMCO KLAY	Baroco	High Yield Blended Clay	Green Band Clay	For use when larger particle size is desired for viscosity and filtration control.
Attapulgit	IMCO BRINEGEL	Zeogel	Salt Gel	Salt Water Gel	Viscosifier in salt water muds.
Beneficiated Bentonite	IMCO HYB	Quick-Gel	Kwik-Thik	Super-Col	Quick viscosity in fresh water upper hole muds with minimum chemical treatment.
Asbestos Fibers	IMCO BEST	Flosal	Flosal	Flosal	Viscosifier for fresh or salt water muds.
Bacterially Produced Polymer	IMCO XC	XC Polymer	Duovis	XC Polymer	Viscosifier and fluid loss control additive for low solids muds.
DISPERSANTS					
Sodium Tetraphosphate	IMCO PHOS	Barafos	Magco-Phos	Oil Fos	Thinner for low pH fresh water muds.
Sodium Acid Pyrophosphate	SAPP	SAPP	SAPP	SAPP	For treating cement contamination.
Quebracho Compound	IMCO QBT	Tannex	M-C Quebracho	Tanco	Thinner for fresh water and lime muds.
Wormlock Extract	IMCO FLO		Rayflo	Rayflo	Thinner for fresh water muds and in muds containing salt (10,000 to 15,000 ppm).
Modified Tannin	DESCO	Desco	Desco	Desco	Thinner for fresh and salt water muds alkalinized for pH control.
Mined Lignite	IMCO LIG	Carbonox	Tann A Thin	Ligon	Dispersant, emulsifier and supplementary additive for fluid loss control.
Causticized Lignite	IMCO THIN	CC-16	Caustilig	Ligon	1-6 ratio caustic-lignite dispersant, emulsifier and supplementary fluid loss additive.
Calcium Lignosulfonate	IMCO CAL		Kembreak		Thinner for SCR and lime muds.
Modified Lignosulfonate	IMCO VC-10	Q-Broxin	Spersene	Uni-Cal	Dispersant and fluid loss control additive for water base muds.
Blended Lignosulfonate Compound	IMCO RD-111				Blended multi-purpose dispersant, fluid loss agent and inhibitor for IMCO RD-111 mud systems.
FLUID LOSS REDUCERS					
Pregelatinized Starch	IMCO LOID	Impermex	My-Lo-Jel	Milstarch	Controls fluid loss in saturated salt water, lime and SCR muds.
Sodium Carboxymethyl Cellulose	IMCO CMC (Regular)	Cellex (Regular)	Magco CMC (Regular)	Milchem CMC (Med-Vis)	For fluid loss control and barite suspension in water base muds.
Sodium Carboxymethyl Cellulose	IMCO CMC (Hi-Vis)	Cellex (Hi-Vis)	Magco CMC (Hi-Vis)	Milchem CMC (Hi-Vis)	For fluid loss control and viscosity building in low solids muds.
Sodium Carboxymethyl Cellulose	IMCO CMC (Tech Grade)	Cellex (Tech Grade)	Magco CMC (Tech Grade)	Milchem CMC (Tech Grade)	For fluid loss control in gyp, sea water and fresh water fluids.
Anionic Cellulose Polymer	DRISPAC	Drispac	Drispac	Drispac	Fluid loss control additive and viscosifier in salt muds.
Sodium Polyacrylate	CYPAN	Cypan	Cypan	Cypan	Fluid loss control in calcium-free low solids and non-dispersed muds.
Sodium Polyacrylate	WL-100	WL-100	WL-100	WL-100	Fluid loss control in calcium-free low solids and non-dispersed muds.

COMPARABLE MUD PRODUCTS BY TRADENAMES — Continued

Description	IMCO SERVICES	Baroid	Magcobar	Milchem	Primary Application
LUBRICANTS, DETERGENTS, EMULSIFIERS					
Extreme Pressure Lubricant	IMCO EP LUBE	EP Mud Lube	Bit Lube	Lubri-Film	Used in water base muds to impart extreme pressure lubricity.
Processed Hydrocarbons	SOLTEX	Soltex	Soltex	Soltex	Used in water base muds to lower down-hole fluid loss and minimize heaving shale.
Water Dispersible Asphalts	IMCO HOLECOAT		STABIL-HOLE	ITI-WD	Lubricant and fluid loss reducer for water base muds that contain no diesel or crude oil.
Oil Dispersible Asphalts	IMCO MUDOIL	Baroid Asphalt	Pave-A-Hole	Carbo-Seal	Lubricant and fluid loss reducer for water base fluids that contain diesel or crude oil.
Oil Soluble Surfactants	IMCO FREEPIPE	Skot-Free	Pipe Lax	Petrocote	Non-weighted fluid for spotting to free differentially stuck pipe.
Detergent	IMCO MD	Con Det	D-D	Milchem MD	Used in water base muds to aid in dropping sand. Emulsifies oil, reduces torque and minimizes bit-balling.
Non-Ionic Emulsifier	DME	Aktaflo-E	SurFak-E	DME	Emulsifier for surfactant muds.
Blend of Anionic Surfactants	IMCO SWS	Trimulso	Salinex	Atlosol & Atlosol S	Emulsifier for salt and fresh water muds.
An Organic Entity Neutralized with Amines	IMCO LUBRIKLEEN	TorqTrim	JOS-3	Mil-Plate 2	Supplies the lubricating properties of oils without environmental pollution.
Blend of Fatty Acids, Sulfonates, & Asphaltic Materials	IMCO SPOT	SF 100			Invert emulsion which may be weighted to desired density for spotting to free differentially stuck pipe.

DEFOAMERS, FLOCCULANTS, BACTERICIDES

Aluminum Stearate	Aluminum Stearate	Aluminum Stearate	Aluminum Stearate	Aluminum Stearate	Defoamer for lignosulfonate muds.
Sodium Alkyl Aryl Sulfonate	IMCO DEFOAM		Magconol Defoamer		Defoamer for salt saturated muds.
Surface Active, Dispersible Liquid Defoamer.	IMCO FOAMBAN	W200 W300		LD-7	All purpose defoamer.
Flocculating Agent	IMCO FLOC	Barafloc	Floxit	Separan	Used to drop drilled solids where clear water is desirable for a drilling fluid.
Paraformaldehyde	IMCO PRESERVALOID	Aldicide	My-Lo-Jel Preservative	Preservative	Prevents starch from fermenting when used in muds of less than saturation or alkalinity less than 1.0 cc.

LOST CIRCULATION MATERIALS

Fibrous Material	IMCO FYBER	Fibertex	Mud Fiber	Mil-Fiber	Filler as well as matting material.
Fibrous Mineral Wool	IMCO WOOL		MagcoWool	Mil-Wool	Often used in areas where acids are later employed to destroy the material.
Walnut Shells:					
Fine	IMCO PLUG	Wall-Nut	Nut-Plug	Mil-Plug	Most often used to prevent lost circulation.
Medium	IMCO PLUG	Wall-Nut	Nut-Plug	Mil-Plug	Used in conjunction with fibers or flakes to regain lost circulation.
Coarse	IMCO PLUG	Wall-Nut	Nut-Plug	Mil-Plug	Used where large crevices or fractures are encountered
Ground Mica:					
Fine	IMCO MYCA	Micatex	Magco-Mica	Milmica	Used for prevention of lost circulation.
Coarse	IMCO MYCA	Micatex	Magco-Mica	Milmica	Forms a good mat at face of well bore.
Cellophane	IMCO FLAKES	Jel Flake	Cell-O-Seal	Milflake	Used to regain lost circulation.
Combination of granules, flakes, and fibrous materials of various sizes in one sack.	IMCO KWIK SEAL	Kwik-Seal	Kwik-Seal	Kwik-Seal	Used where large crevices or fractures are encountered.
Blended high fluid loss soft plugging material.	DIASEAL M	Diaseal M	Diaseal M	Diaseal M	One sack mixture for preparing soft plugs for severe lost circulation.

COMPARABLE MUD PRODUCTS BY TRADENAMES — Continued

Description	IMCO SERVICES	Baroid	Magco	Milchem	Primary Application
SPECIALTY PRODUCTS					
Inhale Control Reagent	IMCO SCR		T-8	Caltrol	Calcium chloride mud for inhibiting the swelling of bentonitic shales.
Bentonite Extender	IMCO GELEX	Benex	Benex	Benex	Increases yield of bentonite to form very low solids drilling fluid.
Non-Ionic Surfactant	DMS	Aktaflo S	SurFak-M	DMS	Primary surfactant for formulating surfactant muds. May be used in hot holes for viscosity stability.
Filming-Amine	IMCO PT-102	Coat-C1815 Coat-415	Magco Inhibitor No. 6	Ami-Tex	Corrosion inhibitor.
Shale Inhibitor	Diammonium Phosphate	Diammonium Phosphate	Diammonium Phosphate	Diammonium Phosphate	For use in specially prepared DAP muds.
Specially Blended Zinc Compounds	IMCO SULF-X			Mil-Guard	For use as a hydrogen sulfide scavenger in water base muds.

COMMERCIAL CHEMICALS

Sodium Chromate	Sodium Chromate	Sodium Chromate	Sodium Chromate	Sodium Chromate	Used in water base muds to prevent high temperature gelation and as a corrosion inhibitor.
Sodium Hydroxide	Caustic Soda	Caustic Soda	Caustic Soda	Caustic Soda	For pH control in water base muds.
Sodium Carbonate	Soda Ash	Soda Ash	Soda Ash	Soda Ash	For treating out calcium sulfate in low pH muds.
Sodium Bicarbonate	Sodium Bicarbonate	Sodium Bicarbonate	Sodium Bicarbonate	Sodium Bicarbonate	For treating out calcium sulfate or cement in high pH muds.
Barium Carbonate	Barium Carbonate	Anhydrox	Barium Carbonate	Barium Carbonate	For treating out calcium sulfate (pH should be above 10 for best results).
Calcium Sulfate	Gypsum	Gypsum	Gypsum	Gypsum	Source of calcium for formulating gyp muds.
Calcium Hydroxide	Lime	Lime	Lime	Lime	Source of calcium for formulating lime muds.
Sodium Chloride	Salt	Salt	Salt	Salt	For saturated salt muds and resistivity control.
Chrome Alum (chromic chloride)	Chrome Alum	Chrome Alum	Chrome Alum	Chrome Alum	For use in cross-linking XC Polymer systems

OIL BASE AND INVERT EMULSION SYSTEMS

Invert Emulsion System	IMCO KENOL-S and IMCO KEN-X	Invermul	Vertoil	Carbu-Tec	Drilling fluids used where extremely high temperatures are encountered also a drilling, completion or workover fluid applicable where only oil contact with formations is desired.
Low Cost Invert Emulsion System	IMCO OIL-X		LoCOM		Inexpensive invert used where low density muds are used and low temperatures are encountered.
*Oil Base Mud	IMCO KEN-SUPREME		Oilfaze		For drilling water sensitive formations.
Gelatinous Oil Base Fluid	IMCO KEN-PAK	SF-100			A time setting gelatinous oil pack for casing recovery and corrosion control.

OIL MUD ADDITIVES

Primary Emulsifier	IMCO KENOL-S(D) and IMCO KEN-X Conc. #1(L)	Invermul	Vertoil	Carbu-Tec(D) and Carbu-Tec(L)	Primary additives to form stable water-in-oil emulsion.
Viscosifier and Gelling Agent	IMCO KEN-GEL and IMCO KEN-X Conc. #2	Gel-Tone and Petro-Tone	VG-69	Carbu-Gel	Provides viscosity, weight suspension, and filtration control.
High Temperature Stabilizer	IMCO KEN-X Conc. #3	Duratone HT	DV-22 and DV-33		Improves emulsion under high temperature conditions.
Stabilizes Borehole Conditions	IMCO VR				Stabilizes running shale, improves emulsion, weight suspension, and fluid loss under high temperature conditions.
Dispersant	IMCO KEN-THIN	OMC and Driitreat	Verthin and SE-11		Dispersant for reducing rheological properties.
Calcium Oxide	IMCO KENOX				Calcium source for saponification

*Black Magic sold by Oil Base, Inc.

COMPARABLE MUD PRODUCTS BY TRADENAMES — Continued

Description	IMCO SERVICES	Baroid	Magcohar	Milcnem	Primary Application
OIL MUD ADDITIVES — Continued					
Fatty Acid Emulsifier	IMCO KEN-SUPREME Conc. A		Oilfare		Primary emulsifier and stabilizer for oil-base drilling fluids
Emulsion Stabilizer	IMCO KEN-SUPREME Conc. B		DG-55		Imparts gels, contributes to viscosity for weight suspension, and provides filtration control.
Specifically Modified, Saponified Fatty Acid Chemicals	IMCO KEN-PAK	SF-100			Gelling agent for formulating high gelation casing packs.
Finely Divided Silicate	IMCO KEN-THERM				Contributes to thixotropic properties and reduces thermal conductivity in Hi-Temp Ken-Pak.

NOTES

BEST
AVAILABLE
COPY

